

CRC1/CRC1+ BACnet® MS/TP Quick Start Guide

Communication Network Wiring

The BACnet MS/TP communication cable connects to terminals 13 and 14 on the terminal strip on the CRC. *Figure 1* shows the terminals on the backside of a CRC.

NOTE: Connect shields together and insulate to prevent accidental grounding.

Daisy chain the CRC onto BACnet MS/TP communication bus with other CRCs and/or other BACnet MS/TP devices as shown in *Figure 1*.

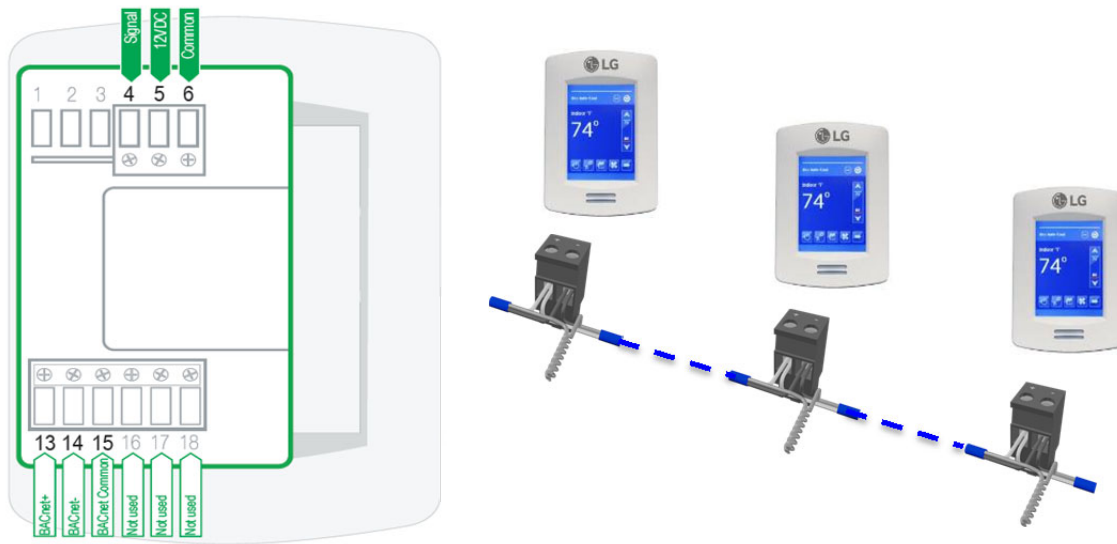
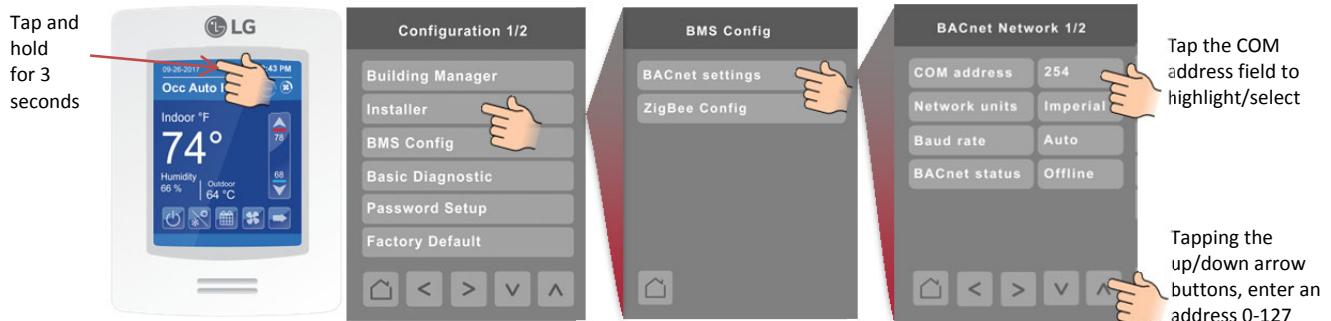

Figure 1

CRC BACnet MS/TP Network Settings

Configuration is required in order to enable the BACnet functionality. The CRC's are shipped with BACnet disabled at COM address of 254. The device must be assigned a unique address within the range of 0 – 127 as follows:



CRC is auto sensing when the Baud rate is set to 'Auto'.

The CRC is now discoverable across the network.

Additional documentation including a complete points list can be found at www.lghvac.com

*BACnet is a registered trademark of ASHRAE