

PURPOSE

Use these instructions to install your Kohler Persona, Mastershower, or Traditional deck-mount handspray without requiring access to the underside of the deck after installation of the finished deck.

NOTE: This kit must be installed before the finished decking materials are installed. Rough decks must maintain a 2-1/8" maximum thickness; finished decks must maintain a 3-7/8" maximum thickness.

TOOLS REQUIRED

- Adjustable wrench
- Drill
- Level
- Pencil
- Safety glasses

INSTALLATION

Verify that the rough deck is level and maintains a 2-1/8" maximum thickness.

Determine placement for the handshower. Drill a 1-1/2" diameter hole in that location.

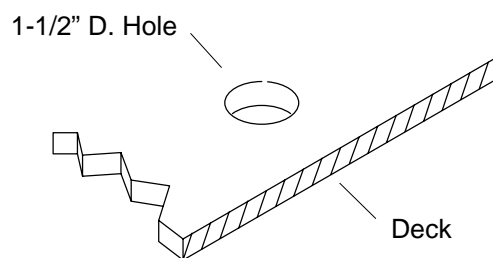

From above the deck, insert the threaded sleeve into the hole.

From the underside of the deck, slide the rubber washer and slip washer onto the threaded sleeve.

Thread the mounting nut onto the threaded sleeve and securely tighten against the underside of the deck.

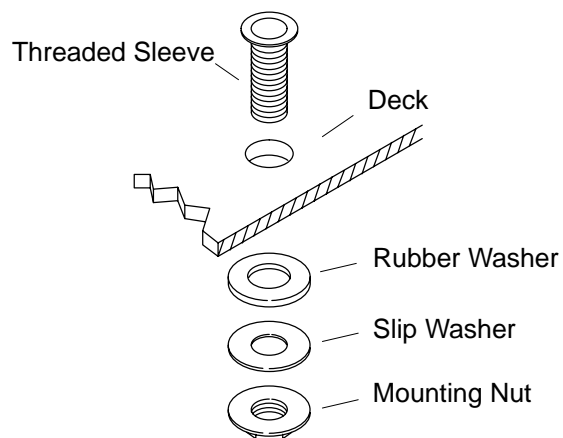

Connect the high pressure hose to the diverter or valve.

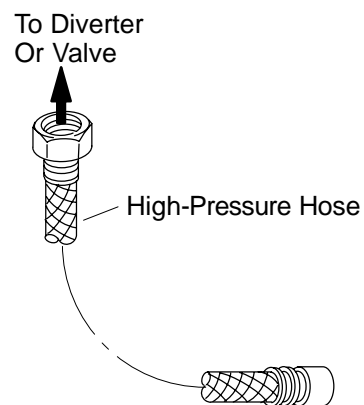

From the underside of the deck, insert the free end of the high pressure hose up through the threaded sleeve.

Thread the rough-in plug to the hose. This will prevent the hose from slipping under the deck.

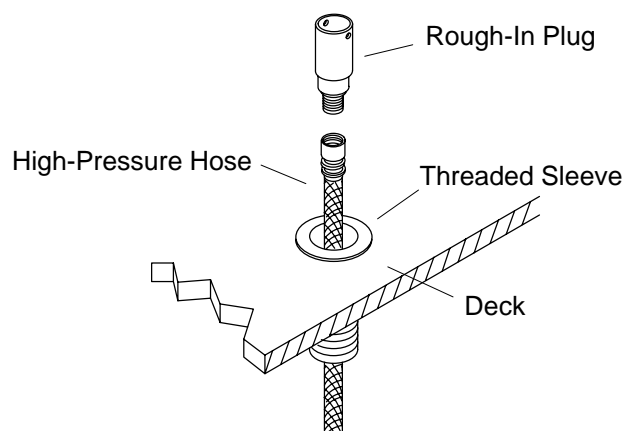

Install the finish decking materials. Verify that the finished deck is level and maintains a 3-7/8" maximum thickness.

Lift the rough-in plug to pull out the hose. Attach the split ring onto the hose to prevent the hose from slipping back under the deck.

Remove the rough-in plug.

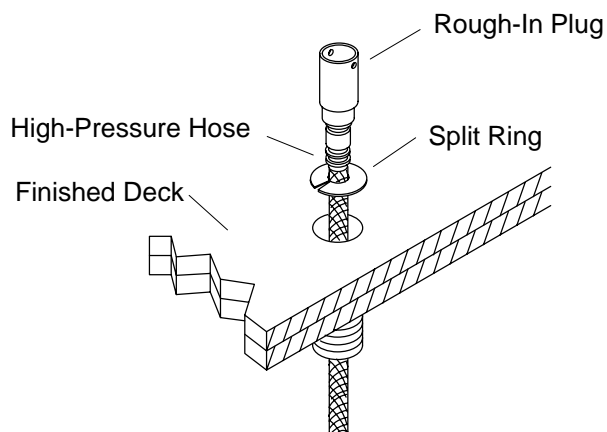

Thread the escutcheon onto the plastic shank (these parts come with your Kohler handshowers).

Slide the smaller end of the decorative hose through the escutcheon, plastic shank, and rubber washer.

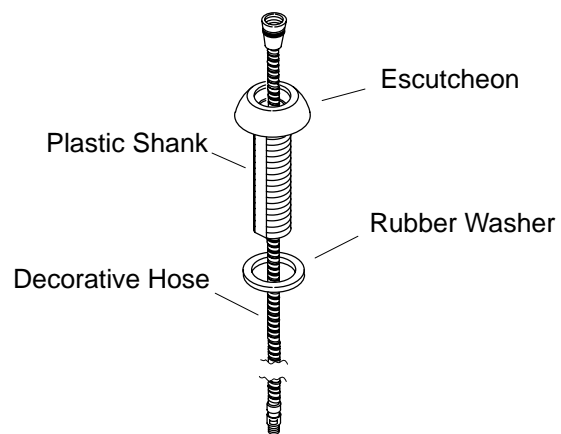

Slide the washer onto the end of the decorative hose.

Thread the decorative hose into the high-pressure hose.

Remove the split ring.

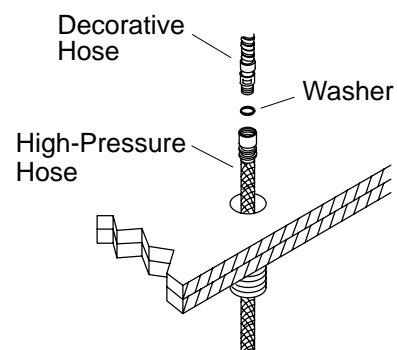

Thread the plastic shank into the threaded sleeve until tight. Do not overtighten.

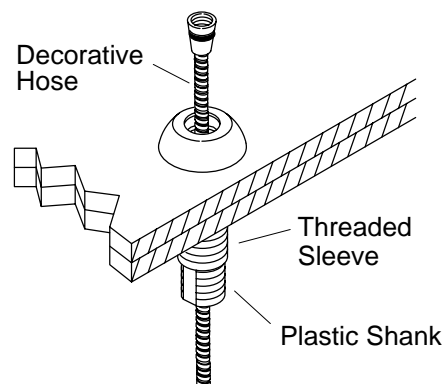

Install the handspray to the end of the decorative hose.

