



# Caxton® Oval

Under-mount Bathroom Sink  
**K-2205**

## Features

- Oval basin.
- Centered drain.
- Fits standard 14- x 17-inch countertop cutout.

## Material

- Vitreous china.

## Installation

- No faucet holes; requires wall- or counter-mount faucet.
- Undermount.

## Recommended Products/Accessories

K-9018 P-Trap  
K-23726 Drain treatment  
K-23725 Cast iron cleaner

## Included Components

Additional Components:  
1193643 Basin clamps



ADA

CSA B651

## Codes/Standards





ASME A112.19.2/CSA B45.1  
ADA  
ICC/ANSI A117.1  
CSA B651

## KOHLER® One-Year Limited Warranty

See website for detailed warranty information.

## Available Colors/Finishes

*Color tiles intended for reference only.*

Color	Code	Description
	0	White
	96	Biscuit
	47	Almond
	55	Innocent Blush™



## Caxton® Oval

### Under-mount Bathroom Sink

#### K-2205

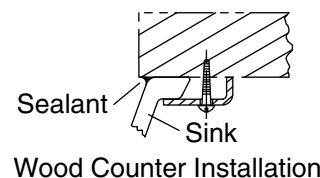
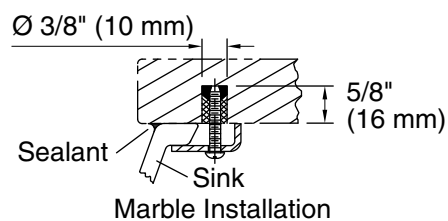
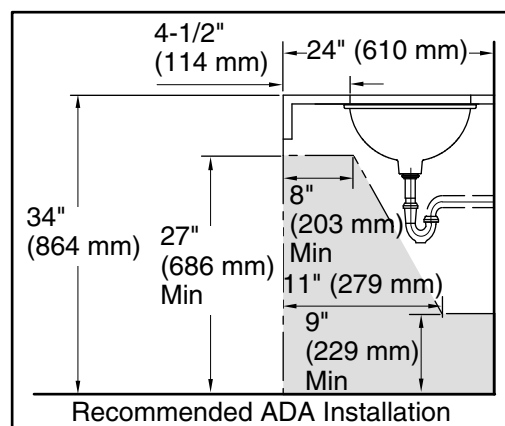
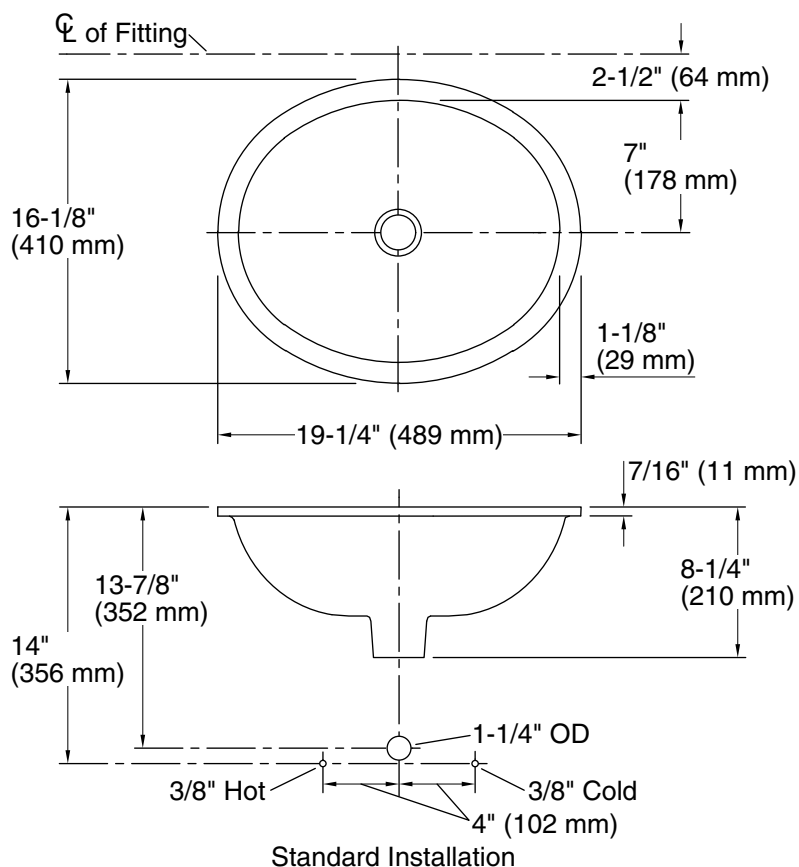

### Technical Information

All product dimensions are nominal.

Bowl configuration:	Single
Installation:	Under-mount
Bowl area (Only):	Length: 17" (432 mm) Width: 14" (356 mm) Water depth: 6-3/8" (162 mm)
Drain hole:	1-3/4" (44 mm)
Template:	1151011-7, required, not included

### Notes

Install this product according to the installation instructions.

NOTICE: Countertop manufacturer or cutter must use the current product template available at [www.kohler.com](http://www.kohler.com), or by calling 1-800-4KOHLER. Kohler Co. is not responsible for cutout errors when the incorrect cutout template is used.

ADA, CSA B651 compliant when installed to the specific requirements of these regulations.