

Submittal Package

viega



Viega® PEX Crimp Zero Lead Eco Brass® Fittings*

Project:

Engineer:

Contractor:

Submitted By:

Potable Water

Other _____

*Eco Brass® is a registered trademark of Chase Brass and Ingot Metal Co.

Viega LLC, 100 N. Broadway, 6th Floor • Wichita, KS 67202 • Ph: 800-976-9819 • Fax: 316-425-7618

SM-PF 0915 (Zero Lead Crimp)

1 of 15

Submittal Package

viiega

Viega PEX Crimp Zero Lead Eco Brass Fittings

Technical Data

Materials:

Fittings.....	Eco Brass®
Crimp Rings.....	Copper (black)
MANABLOC® Manifolds.....	Polysulfone (plastic) with Eco Brass or PolyAlloy™ fittings
PEX Crimp Copper Manifolds.....	Copper with Eco Brass alloy fittings
PEX Crimp Poly Manifolds.....	PolyAlloy crimp connections
Valves.....	Eco Brass and PolyAlloy
ViegaPEX™, ViegaPEX Ultra Tubing.....	PEX (crosslinked polyethylene)

Applications

PEX zero lead brass and PolyAlloy PEX Crimp fittings are intended for use in potable water systems. They can be directly buried in soil but shall be wrapped (fittings used in concrete shall also be wrapped). Fittings are manufactured with PEX Crimp barbs for use with ViegaPEX, ViegaPEX Ultra tubing, crimp rings and tools.

Installation

- Use only ASTM F1807 crimp rings and approved full circle crimp tools to make connections.
- Keep flame and excessive heat away from tubing and connections.
- Refer to the PEX Water Systems Installation Manual for additional information.

“Zero Lead” identifies Viega® products meeting the lead free requirements of NSF 61-G through testing under NSF/ANSI 372 (0.25% or less maximum weighted average lead content).

Codes Approvals & Standards

ANSI/NSF 61-G

cNSF® us pw-G

CSA B137.5

U.P. Code

UPC®

ASTM F876 / F877

ASTM F1807 / F2159

ICC ES-PMG™ 1038

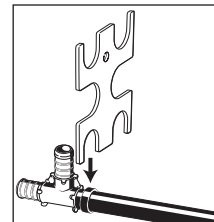
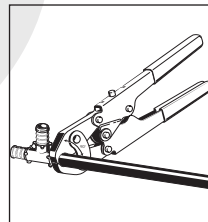
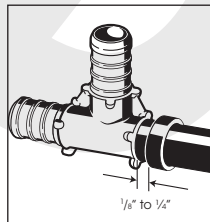

THREE SIMPLE STEPS TO A SECURE PEX CRIMP FITTING CONNECTION.

1. SLIDE CRIMP RING OVER END OF SQUARED OFF TUBING, FULLY INSERT FITTING INTO TUBING AND POSITION THE RING 1/8" TO 1/4" FROM THE END OF TUBING.
2. KEEP THE TOOL AT 90° AND CLOSE THE HANDLES COMPLETELY. DO NOT CRIMP TWICE.
3. CHECK CRIMP WITH GO/NO GO GAUGE.

Submittal Package



Viega PEX Crimp Zero Lead Eco Brass Fittings

ViegaPEX and ViegaPEX UltraTubing

Material.....PEX crosslinked polyethylene
 Temperature/Pressure Ratings...200°F at 80 psi
 180°F at 100 psi
 73.4°F at 160 psi
 Linear Expansion Rate.....1.1"/100'/10°F

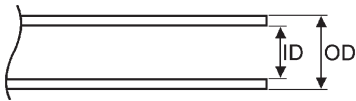

Nominal Size	Inner Diameter	Outer Diameter	Wall Thickness
3/8"	0.35	0.500±.003	0.070±.010
1/2"	0.47	0.625±.004	0.070±.010
3/4"	0.67	0.875±.004	0.097±.010
1"	0.86	1.125±.005	0.125±.013

Submittal Package

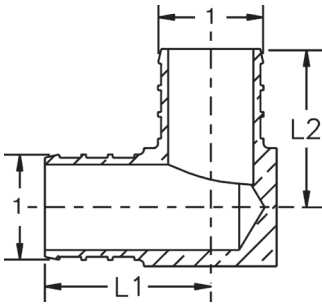

Viega PEX Crimp 90° Elbow Zero Lead Brass - Model V5016ZL

Part Number	Size		L1 (in)	L2 (in)
	1	2		
46922	3/8"		0.89	0.87
46933	1/2"		0.95	0.87
46243	3/4" x 1/2"		1.06	1.01
46944	3/4"		1.06	1.00
46955	1"		1.36	1.36

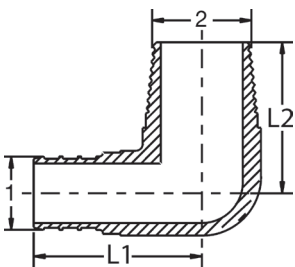

Viega PEX Crimp 90° Elbow Zero Lead Brass Crimp x MPT - Model V5014ZL

Part Number	Size		L1 (in)	L2 (in)
	1	2		
46822	3/8" x 3/8" M NPT		1.03	0.96
46232	1/2" x 3/8" M NPT		1.29	0.96
46821	1/2" x 1/2" M NPT		1.11	1.19
46245	3/4" x 3/4" M NPT		1.50	1.26

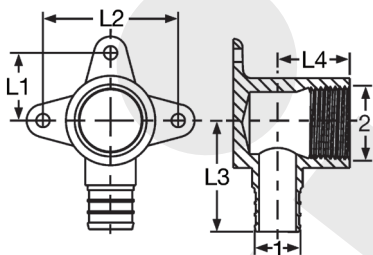

Viega PEX Crimp 90° Elbow Drop Ear Zero Lead Brass Crimp x FPT - Model V5027ZL

Part Number	Size		L1 (in)	L2 (in)	L3 (in)	L4 (in)
	1	2				
46233	1/2" x 1/2" F NPT		0.79	1.58	1.39	0.72
46244	3/4" x 3/4" F NPT		0.99	1.98	1.46	1.05

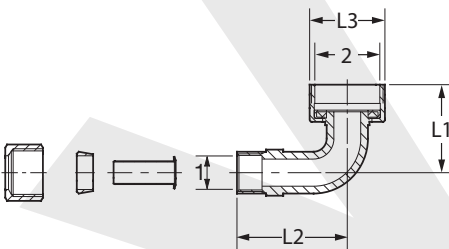

Viega PEX Compression 90° Elbow For Dishwasher Zero Lead Copper CTS x Hose - Model V5053

Part Number	Size		L1 (in)	L2 (in)	L3 (in)
	1	2			
46743	3/8" CTS (1/2" O.D.) Comp	3/4" Hose	1.32	1.67	1.14

Submittal Package

viega

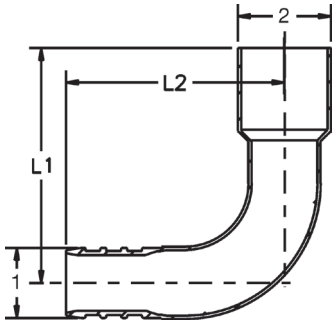

Viega PEX Crimp 90° Elbow Zero Lead Copper Crimp x C - Model V5021

Part Number	Size	L1 (in)	L2 (in)
	1 2		
44305	3/8" x 1/2" F Copper	1.68	1.46
44325	1/2" x 1/2" F Copper	1.43	1.58
44345	3/4" x 3/4" F Copper	2.05	2.01

Viega PEX Crimp 90° Elbow Zero Lead Copper Crimp x FTG - Model V5020

Part Number	Size	L1 (in)	L2 (in)
	1 2		
44302	3/8" x 1/2" M Copper	1.65	1.56
44320	1/2" x 1/2" M Copper	1.44	1.49
44340	3/4" x 3/4" M Copper	1.94	1.87

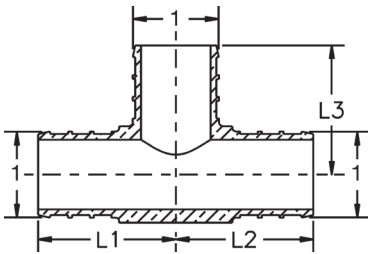

Viega PEX Crimp Tee Zero Lead Brass - Model V5018ZL

Part Number	Size	L1 (in)	L2 (in)	L3 (in)
	1			
46500	3/8"	0.89	0.89	0.88
46520	1/2"	0.95	0.95	0.88
46524	1/2" x 1/2" x 3/4"	1.07	1.07	1.01
46540	3/4"	1.07	1.07	1.00
46433	3/4" x 1/2" x 1/2"	1.20	1.20	1.10
46435	3/4" x 1/2" x 3/4"	1.07	1.12	1.01
46443	3/4" x 3/4" x 1/2"	1.07	1.07	1.01
46445	3/4" x 3/4" x 1"	1.21	1.21	1.25
46544	3/4" x 1" x 3/4"	1.20	1.39	1.10
46545	3/4" x 1" x 1"	1.21	1.39	1.28
46553	1" x 1" x 1/2"	1.39	1.39	1.10
46554	1" x 1" x 3/4"	1.39	1.39	1.10
46560	1"	1.36	1.36	1.36

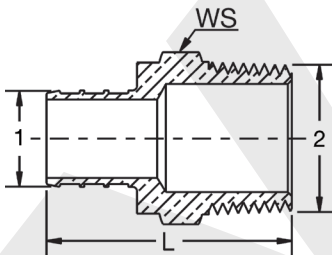

Viega PEX Crimp Adapter Zero Lead Brass Crimp x MPT - Model V5011ZL

Part Number	Size	L (in)	WS (in)
	1 2		
46302	3/8" x 1/2" M NPT	1.63	0.88
46321	1/2" x 1/2" M NPT	1.65	0.88
46324	1/2" x 3/4" M NPT	1.84	1.06
46342	3/4" x 1/2" M NPT	1.68	0.88
46340	3/4" x 3/4" M NPT	1.84	1.06
46446	3/4" x 1" M NPT	2.07	1.38
46361	1" x 3/4" M NPT	2.02	1.06
46366	1" x 1" M NPT	2.25	1.38

Submittal Package

viega

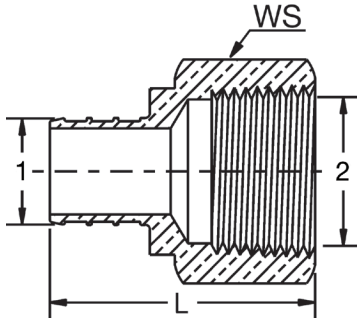

Viega PEX Crimp Adapter Zero Lead Brass Crimp x FPT - Model V5012ZL

Part Number	Size	L (in)	WS (in)
	1 2		
46323	3/8" x 1/2" F NPT	1.62	1.00
46333	1/2" x 1/2" F NPT	1.62	1.00
46334	1/2" x 3/4" F NPT	1.67	1.25
46344	3/4" x 3/4" F NPT	1.67	1.25
46345	3/4" x 1" F NPT	1.89	1.50
46355	1" x 1" F NPT	2.07	1.50

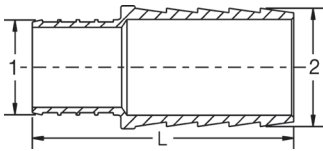

Viega PEX Crimp Adapter Zero Lead Brass Crimp x PB - Model V5017ZL

Part Number	Size	L (Inches)
	1 2	
46145	3/4" x 3/4" PE	1.94
46156	1" x 1" PE	2.39

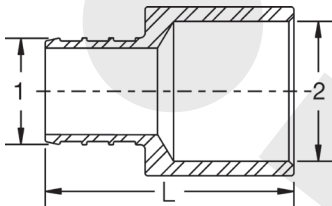

Viega PEX Crimp Adapter Zero Lead Brass Crimp x C - Model V5045ZL

Part Number	Size	L (in)
	1 2	
46635	1/2" x 1/2" F Sweat	1.33
46645	3/4" x 3/4" F Sweat	1.57

Viega PEX Crimp Adapter Zero Lead Copper Crimp x C - Model V5045ZL

Part Number	Size	L (in)
	1 2	
40655	1" x 1" F Sweat	2.13

Submittal Package

viega

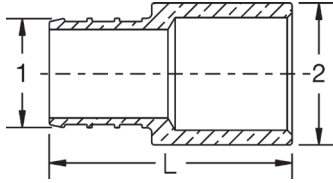

Viega PEX Crimp Adapter Zero Lead Brass Crimp x FTG - Model V5046ZL

Part Number	Size		L (in)
	1	2	
46633	1/2" x 1/2" M Sweat		1.33
46644	3/4" x 3/4" M Sweat		1.50

Viega PEX Crimp Adapter Zero Lead Copper Crimp x FTG - Model V5046ZL

Part Number	Size		L (in)
	1	2	
60651	1" x 1" M Sweat		1.97

Viega PEX Crimp Adapter Zero Lead Brass Crimp x C x FTG - Model V5042ZL

Part Number	Size		L (in)
	1	2	
46621	3/8" x 3/8" M Sweat or 1/4" F		1.33
46622	3/8" x 1/2" M Sweat or 3/8" F		1.33
46631	1/2" x 3/8" M Sweat or 1/4" F		1.46
46654	1" x 1" M Sweat or 3/4" F		1.92

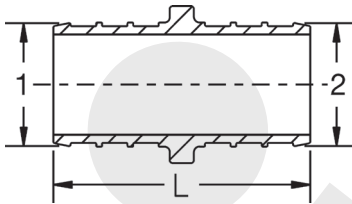

Viega PEX Crimp Coupling Zero Lead Brass - Model V5015ZL

Part Number	Size		L (Inches)
	1	2	
46422	3/8"		1.39
46432	1/2" x 3/8"		1.39
46434	1/2"		1.39
46441	3/4" X 1/2"		1.39
46444	3/4"		1.39
46454	1" X 3/4"		1.57
46455	1"		1.75

Submittal Package

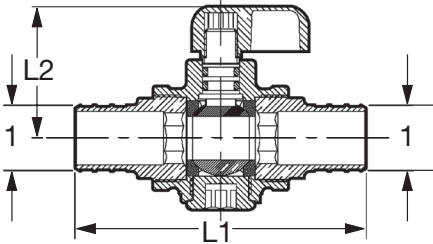

Viega PEX Crimp Ball Valve Zero Lead Brass 1/4 Turn - Model V5037ZL

Part Number	Size	L1 (in)	L2 (in)
	1		
46010	3/8"	3.09	1.20
46031	1/2"	2.76	1.20
46044	3/4"	2.95	1.30

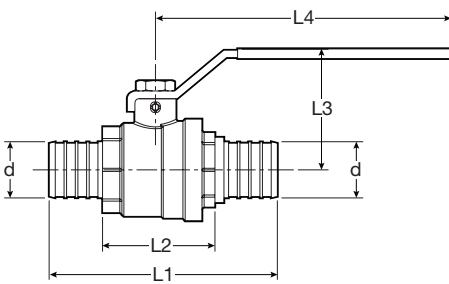

Viega PEX Crimp Ball Valve Zero Lead Brass 1/4 Turn - Model V5037ZL

Part Number	Size	L1 (in)	L2 (in)	L3 (in)	L4 (in)
	d x d				
46060	1" x 1"	3.41	1.71	1.84	4.50

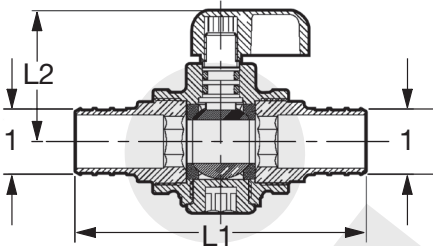

Viega PEX Crimp Ball Valve Zero Lead Chrome Plated Brass 1/4 Turn - Model V5023ZL

Part Number	Size	L1 (in)	L2 (in)
	1		
46021	1/2"	2.76	1.20

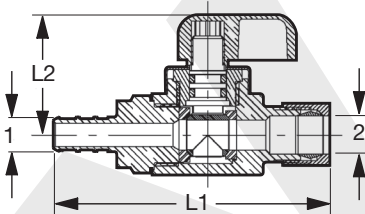

Viega PEX Crimp Stop Valve Straight Zero Lead Chrome Plated Brass Crimp x CTS 1/4 Turn - Model V5026ZL

Part Number	Size	L1 (in)	L2 (in)
	1 2		
46001	3/8" x 1/4" CTS (3/8" OD) Comp	2.78	1.20
46022	1/2" x 1/4" CTS (3/8" OD) Comp	2.78	1.20

Submittal Package

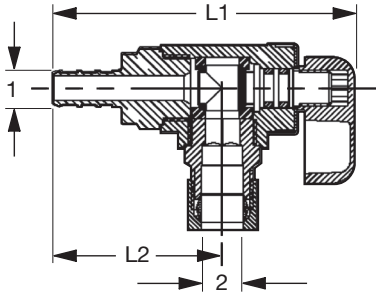

Viega PEX Crimp Stop Valve Angled Zero Lead Chrome Plated Brass Crimp x CTS 1/4 Turn - Model V5064ZL

Part Number	Size	L1 (in)	L2 (in)
	1 2		
46002	3/8" x 1/4" CTS (3/8" OD) Comp	2.70	1.03
46025	1/2" x 1/4" CTS (3/8" OD) Comp	2.80	1.03

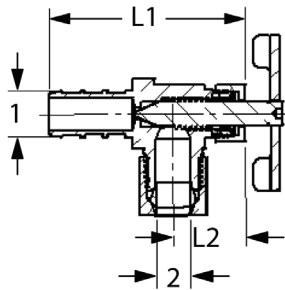

Viega PEX Crimp Adapter Straight Zero Lead Brass For Ice Maker Crimp x CTS - Model V5051ZL

Part Number	Size	L1 (in)	L2 (in)
	1 2		
46301	3/8" x 1/8" CTS (1/4" OD) Comp	1.48	0.55
46322	1/2" x 1/8" CTS (1/4" OD) Comp	1.48	0.55

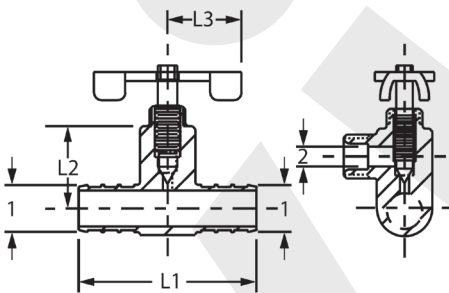

Viega PEX Crimp Tee Zero Lead Brass For Ice Maker Crimp x Crimp x CTS - Model V5062ZL

Part Number	Size	L1 (in)	L2 (in)	L3 (in)
	1 2			
46503	3/8" x 1/8" CTS (1/4" OD) Comp	1.83	1.03	0.59
46521	1/2" x 1/8" CTS (1/4" OD) Comp	1.83	1.03	0.59

Submittal Package

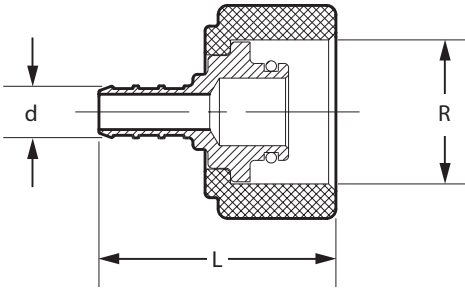

Viega PEX Crimp Port Adapter Zero Lead Brass For ManaBloc Crimp x Port - Model V5039ZL

Part Number	Size		L (in)
	1	2	
46624	3/8" x 1/2" Port		1.58
46634	1/2" x 1/2" Port		1.58

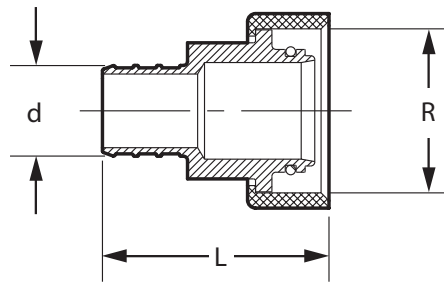

Viega PEX Crimp Supply Adapter Zero Lead Brass For ManaBloc Crimp x Supply - Model V5034ZL

Part Number	Size		L (in)
	1	2	
46414	3/4" x 1" ManaBloc		1.66
46416	1" x 1" ManaBloc		1.84

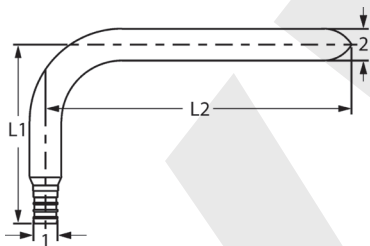

Viega PEX Crimp Stub-Out 90° Elbow Zero Lead Copper Crimp x Street - Model V5070

Part Number	Size		L1 (in)	L2 (in)
	1	2		
44208	3/8" x 1/2" Copper		3.50	7.75
44226	1/2" x 1/2" Copper		3.50	5.75
44228	1/2" x 1/2" Copper		3.50	7.75
44240	3/4" x 3/4" Copper		4.50	8.00

Submittal Package

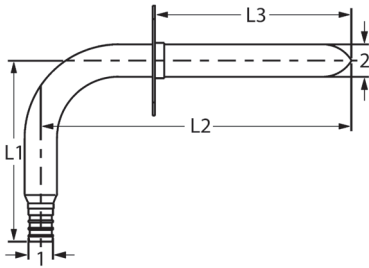

Viega PEX Crimp Stub-Out 90° Elbow Zero Lead Copper Crimp x Street with Wall Plate - Model V5070.1

Part Number	Size	L1 (in)	L2 (in)	L3 (in)
	1 2			
44209	3/8" x 1/2" Copper	3.50	7.75	6.00
44227	1/2" x 1/2" Copper	3.50	5.75	4.00
44229	1/2" x 1/2" Copper	3.50	7.75	6.00

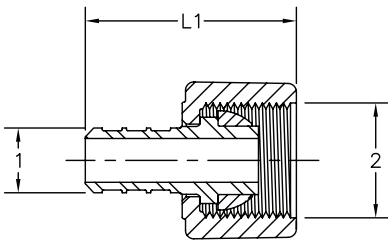

Viega PEX Crimp Lav Adapter Zero Lead Brass Crimp x Lav - Model V5075ZL

Part Number	Size	L1 (in)
	1 2	
46023	3/8" x 1/2" Lav (plastic nut)	1.65
46033	1/2" x 1/2" Lav (plastic nut)	1.65
46024	3/8" x 1/2" Lav (brass nut)	1.65
46034	1/2" x 1/2" Lav (brass nut)	1.65
46040	3/4" x 3/4" Lav (brass nut)	1.70

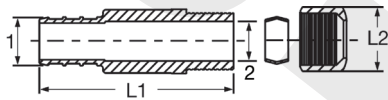

Viega PEX Crimp Lav Adapter Zero Lead Brass Crimp x CTS - Model V5077ZL

Part Number	Size	L1 (in)	L2 (in)
	1 2		
46032	3/8" x 1/4" CTS (3/8" OD) Comp	1.76	0.63
46331	1/2" x 1/4" CTS (3/8" OD) Comp	1.76	0.63

Submittal Package

viega

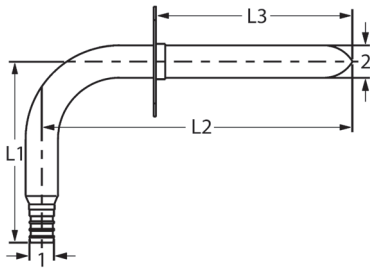

Viega PEX Crimp Stub-Out 90° Elbow Zero Lead Copper Crimp x Street with Wall Plate - Model V5070.1

Part Number	Size	L1 (in)	L2 (in)	L3 (in)
	1 2			
44209	3/8" x 1/2" Copper	3.50	7.75	6.00
44227	1/2" x 1/2" Copper	3.50	5.75	4.00
44229	1/2" x 1/2" Copper	3.50	7.75	6.00

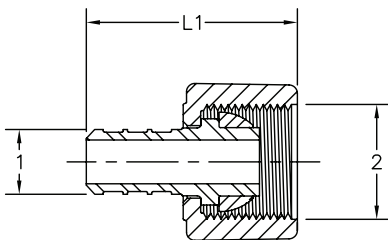

Viega PEX Crimp Lav Adapter Zero Lead Brass Crimp x Lav - Model V5075ZL

Part Number	Size	L1 (in)
	1 2	
46023	3/8" x 1/2" Lav (plastic nut)	1.65
46033	1/2" x 1/2" Lav (plastic nut)	1.65
46024	3/8" x 1/2" Lav (brass nut)	1.65
46034	1/2" x 1/2" Lav (brass nut)	1.65
46040	3/4" x 3/4" Lav (brass nut)	1.70

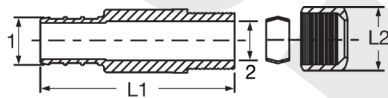

Viega PEX Crimp Lav Adapter Zero Lead Brass Crimp x CTS - Model V5077ZL

Part Number	Size	L1 (in)	L2 (in)
	1 2		
46032	3/8" x 1/4" CTS (3/8" OD) Comp	1.76	0.63
46331	1/2" x 1/4" CTS (3/8" OD) Comp	1.76	0.63

Submittal Package

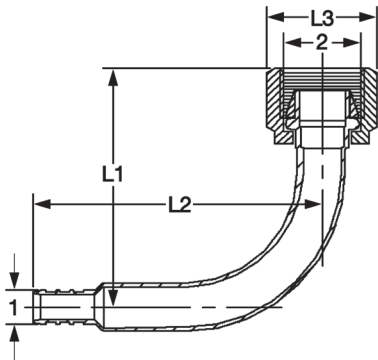

Viega PEX Crimp Lav 90° Elbow Zero Lead Copper Crimp x Lav - Model V5076

Part Number	Size	L1 (in)	L2 (in)	L3 (in)
	1 2			
44201	3/8" x 1/2" Lav (plastic nut)	2.25	2.73	1.12

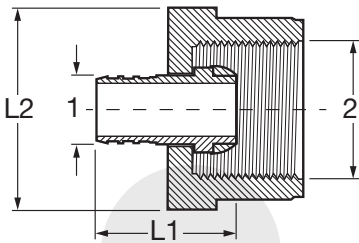

Viega PEX Crimp Closet Adapter Zero Lead Brass Crimp x Closet - Model V5072ZL

Part Number	Size	L1 (in)	L2 (in)
	1 2		
46223	3/8" x 1/2" Closet (plastic nut)	1.36	1.16
46234	1/2" x 1/2" Closet (plastic nut)	1.36	1.16

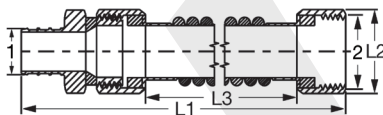

Viega PEX Crimp Swivel Connector Zero Lead Copper For Water Heater Crimp x FPT - Model V5048ZL

Part Number	Size	L1 (in)	L2 (in)	L3 (in)
	1 2			
46764	3/4" x 3/4" F NPT	19.00	1.13	18.00

Submittal Package

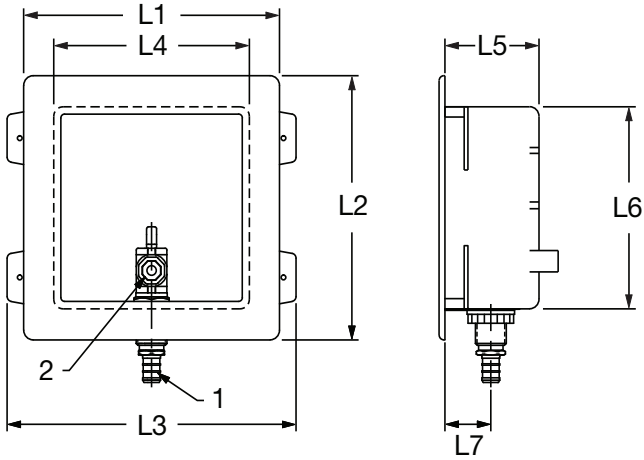

Viega PEX Crimp Outlet Box Zero Lead Brass For Ice Maker 1/4 Turn - Model 2872ZL

Part Number	Size		L1	L2	L3	L4	L5	L6	L7
	1	2							
46710*	3/8" x 1/8" CTS (1/4" O.D.)		6.80"	6.80"	7.68"	5.20"	2.50"	5.20"	1.22"
46720*	1/2" x 1/8" CTS (1/4" O.D.)		6.80"	6.80"	7.68"	5.20"	2.50"	5.20"	1.22"
43700	3/8" x 1/8" CTS (1/4" O.D.)		6.80"	6.80"	7.68"	5.20"	2.50"	5.20"	1.22"
43722	1/2" x 1/8" CTS (1/4" O.D.)		6.80"	6.80"	7.68"	5.20"	2.50"	5.20"	1.22"

* with hammer arrestor

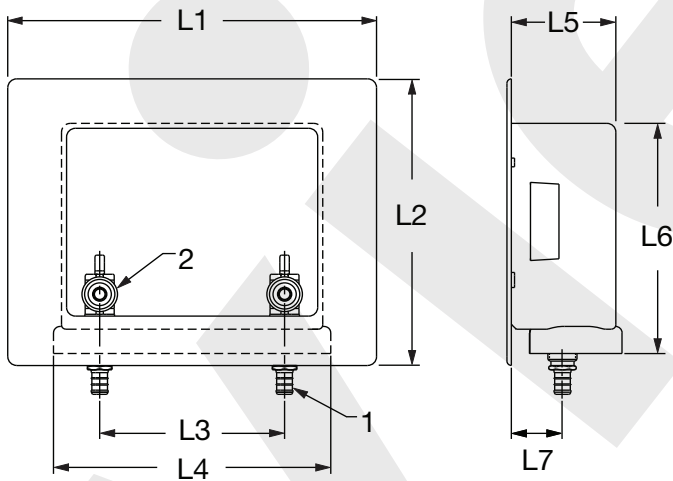

Viega PEX Crimp Outlet Box Zero Lead Brass For Washing Machine 1/4 Turn - Model 2872.9ZL

Part Number	Size		L1	L2	L3	L4	L5	L6	L7
	1	2							
46730*	1/2" x 3/4" Hose		10.40"	8.30"	5.20"	7.40"	2.90"	6.60"	1.43"
43720	1/2" x 3/4" Hose		10.40"	8.30"	5.20"	7.40"	2.90"	6.60"	1.43"

* with hammer arrestor

Submittal Package

viega

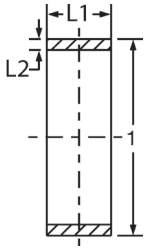

Viega PEX Crimp Ring Copper - Model V5019.9

Part Number	Size	L1 (in)	L2 (in)
	1		
43600	3/8"	0.32	0.05
43620	1/2"	0.32	0.05
43640	3/4"	0.32	0.05
43660	1"	0.36	0.04

This document subject to updates. For the most current Viega technical literature please visit www.viega.us.
Click Services -> Click Electronic Literature Downloads -> Select Product Line -> Select Desired Document

Viega LLC, 100 N. Broadway, 6th Floor • Wichita, KS 67202 • Ph: 800-976-9819 • Fax: 316-425-7618