

PRODUCT SPECIFICATIONS

Sensor Lavatory Deck Mount Faucet. Faucet has a flow rate of .5 GPM, and is made of Chrome Plated Brass material, with a Electronic Control Module valve. Faucet requires 3 faucet holes.

Mounting Type:	Deck Mount
Special Features:	Low Flow Hands free
Finish:	Chrome
Handle Type:	Sensor Operated (Hands Free)
Deck Clearance:	2-3/16"
Spout Reach:	4-9/16"
Spout Height:	3-5/8"
Hole Drillings:	3
Material:	Chrome Plated Brass
Valve Type:	Electronic Control Module
Valve Connection:	3/8" Female Compression Hose Assembly
Flow Rate:	.5 GPM
Faucet Hole Spread:	2"
Spout Swing Rotation:	0°
Spout Type:	Fixed Spout



Included with Product: Appropriate mounting hardware

AMERICAN PRIDE. A LIFETIME TRADITION. Like your family, the Elkay family has values and traditions that endure. For almost a century, Elkay has been a family-owned and operated company, providing thousands of jobs that support our families and communities.



Product Compliance: ADA
ASME A112.18.1/CSA B125.1
NSF 372 (lead free)
NSF 61

[Clean and Care Manual \(PDF\)](#)

[Installation Instructions \(PDF\)](#)

[Limited Warranty \(PDF\)](#)

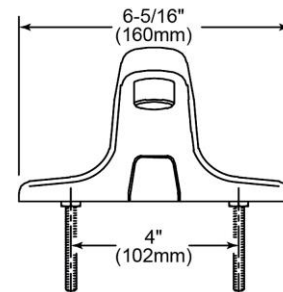
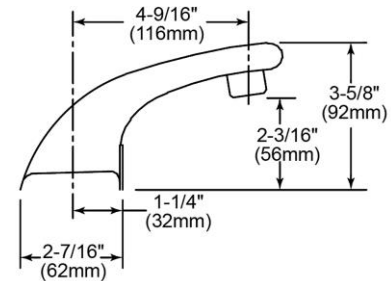

PART: _____ QTY: _____

PROJECT: _____

CONTACT: _____

DATE: _____

NOTES: _____

APPROVAL: _____

In keeping with our policy of continuing product improvement, Elkay reserves the right to change product specifications without notice. Please visit elkay.com for the most current version of Elkay product specification sheets. This specification describes an Elkay product with design, quality, and functional benefits to the user. When making a comparison of other producers' offerings, be certain these features are not overlooked.

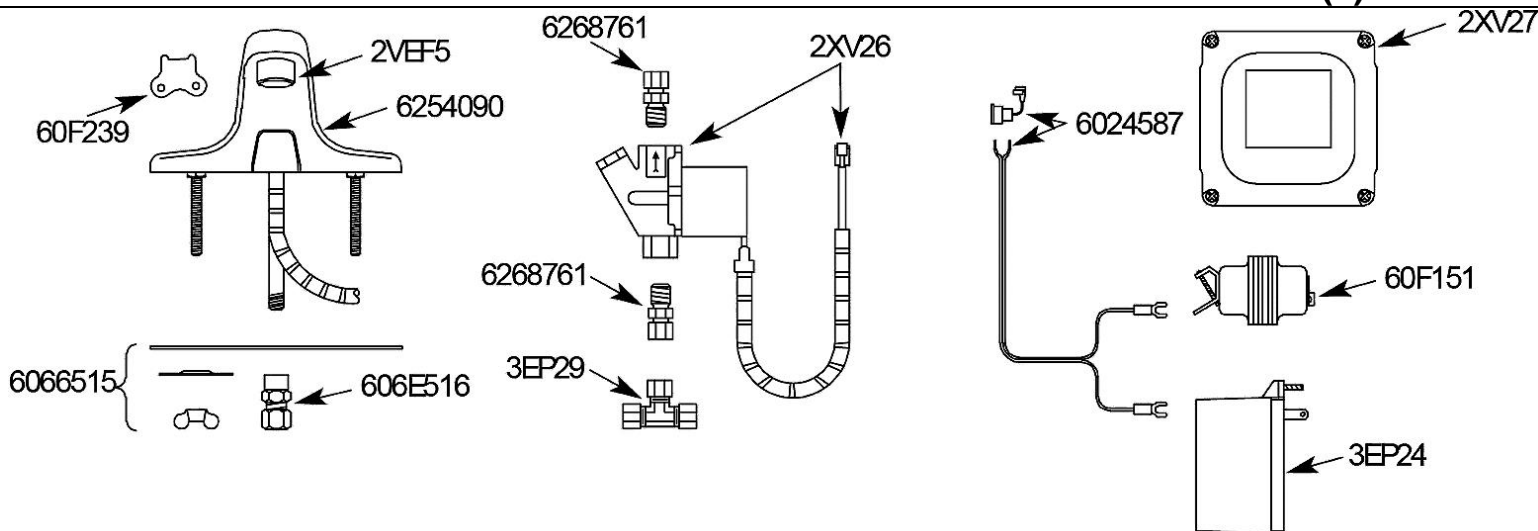

Part No.	Description
6254090	Faucet Spout and Sensor Assembly (EFT-600)
2VEFS	0.5 gpm (1.9Lpm) Spray Head with Key (male thread)
60F239	Replacement Key Only for ETF-1023-A Spray Head and ETF-1024-A Aerator Sprav Head
6066515	Faucet Mounting Kit includes: Base Gasket, two (2) Slotted Mounting Washers, two (2) Wing Nuts and Compression Fitting Connector
606E516	1/8" (3mm) NPT Pipe to 3/8" (10mm) Tube Compression Fitting Connector
3EP29	3/8" (10mm) Bak-Chek® Tee Compression Fitting
2XV26	24 VAC Solenoid Valve Assembly, includes Wire Harness
6268761	Assembly Kit includes: Compression Fittings (2), Compression Nut (1). Compression Sleeve (1)
2XV27	Control Module Assembly
3EP24	Plug-in Transformer
60F151	Box Mount Transformer
6024587	Power Cable with Strainer Relief and Crimp Connector (Transformer to Control Module)

In keeping with our policy of continuing product improvement, Elkay reserves the right to change product specifications without notice. Please visit elkay.com for the most current version of Elkay product specification sheets. This specification describes an Elkay product with design, quality, and functional benefits to the user. When making a comparison of other producers' offerings, be certain these features are not overlooked.