



**Escale®**  
elongated toilet seat  
**K-E70004**

**Features**

- Metal hinges.
- Closed-front seat.

**Material**

- Plastic.

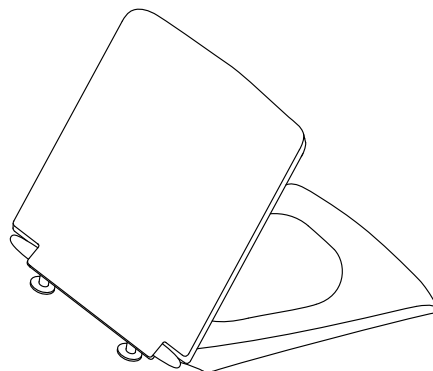

**Codes/Standards**



None Applicable

**KOHLER® One-Year Limited Warranty**

See website for detailed warranty information.

**Available Colors/Finishes**

*Color tiles intended for reference only.*

Color	Code	Description
	0	White
	96	Biscuit
	47	Almond

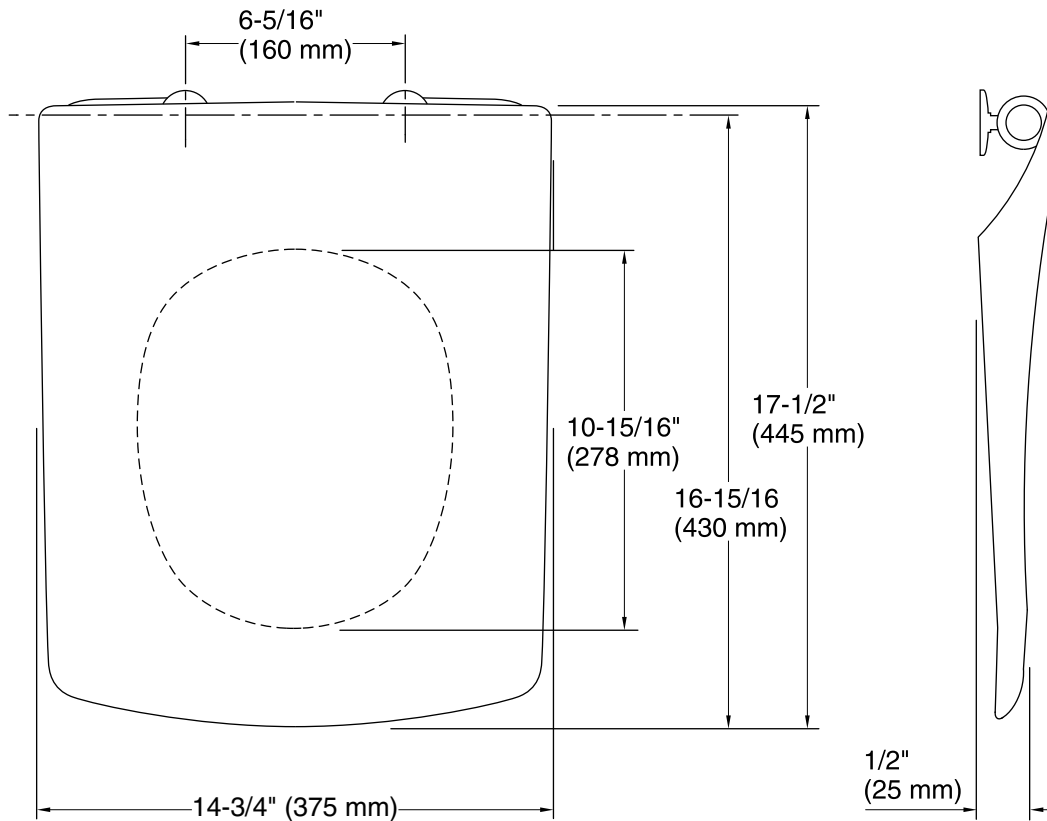

## Technical Information

All product dimensions are nominal.

Seat shape type: Elongated

Seat front type: Closed-front

Seat-mounting holes: 6-5/16" (160 mm)