

OVERHEAD BRACKETING SYSTEM

523 SERIES

Powerbar™ Mini Strut

SPECIFICATION

Sioux Chief 523-2MS series PowerBar™ Mini Strut shall be used where necessary for hanging pipes overhead from 3/8" threaded rod. Bracket shall be corrosion resistant. System shall include adjustable channel clamps with elastomer inserts for fastening any pipe, tube, cable, etc. up to 2" maximum diameter when used with Sioux Chief Touchdown or TD+™ universal clamps. System shall be approved for use with insulated or non-insulated copper, CPVC tube, PEX/PB tube, steel pipe, CSST lines, plastic or steel conduit. System shall be UV resistant. System shall be UV resistant. System shall be IAPMO certified.

INSTALLATION

Once adjustable clamps are installed in bracket channel, insert 3/8" all-thread rod to suspend bracket, using approved 3/8" hex nuts and washers (not provided). When specified, use hardware above and below bracket channel. Slide adjustable clamps to desired position within bracket channel. Place conduit between clamp posts and engage clamp bridge. Ratchet bridge of channel clamp down over both posts evenly. It is permissible to install optional Sioux Chief TD+™ universal clamp or any approved galvanized two-hole pipe strap to bracket channel by installing conduit into pipe strap and then securing pipe strap to bracket with approved #6 – #10 screws.

MATERIALS

Bracket: 20 gauge galvanized steel
Channel clamp: Nylon 66, UL94 V2 flame rating
Clamp insert: TPE

SAFE WORKING LOAD

Bracket:	70 lbs	Channel clamp:	Temp	Safe load
			-10°F " – 130°F	70 lbs.
			131°F " – 179°F	38 lbs.
			180°F " – 220°F	12 lbs.

*Safe working load = 1/2 failure of centrally hung load

DIMENSIONS

A: Channel clamp post	1 7/8"
B: Channel clamp capacity	1/4" – 1 3/8"
C: Channel clamp base	1 7/8"
D: Pilot hole spacing	0.203" on center
E: All-thread hole diameter	0.39"
F: Bracket length	13 5/8"
G: Bracket height	0.529"
H: Bracket width	0.602"
I: Pilot hole diameter	0.1"
J: Metal thickness	0.036"
K: Spacing between all-thread holes	12 3/4" on center

ITEM # SUBMITTED	_____
JOB NAME	_____
LOCATION	_____
ENGINEER	_____
CONTRACTOR	_____
PO#	_____ TAG _____

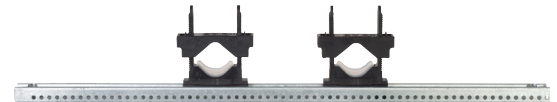

523-2MS2

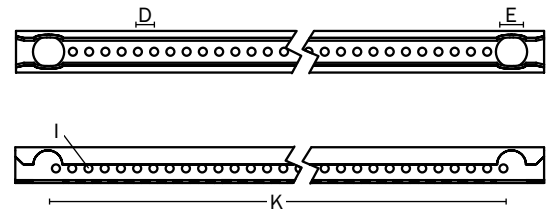
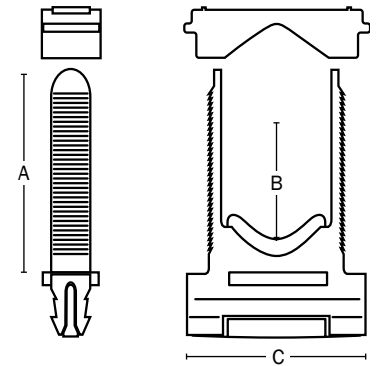

Made in USA

Create Item Number

523-2MSA

e.g. 523-2MS4: steel bracket with four channel clamps

BRACKET CONFIGURATION A

- = bracket only, no channel clamps
- 2 = bracket, two channel clamps
- 3 = bracket, three channel clamps
- 4 = bracket, four channel clamps