

For 110 Through 120

EFFECTIVE: April 13, 2015

SUPERSEDES: July 10, 2014

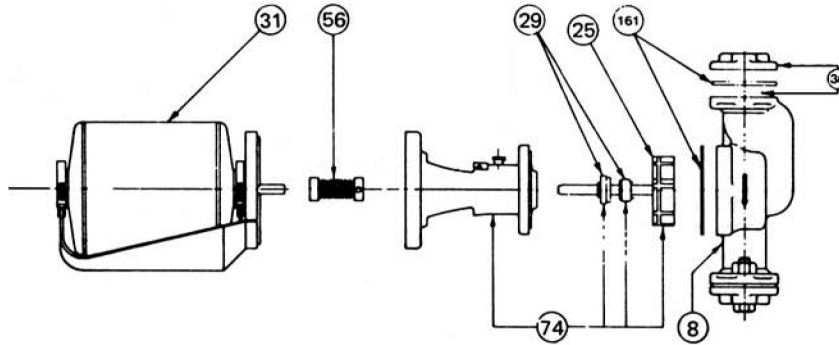

REFER TO 103-104 FOR LIST PRICES

ITEM #3 BODY GASKET

| MODEL NUMBER | PART NUMBER |
|---------------------|-------------|
| HC, 110, 112 & 117 | 110-364RP |
| HDH, 111, 113 & 120 | 120-009RP |

ITEM #29 SEAL

| MODEL NUMBER | PART NUMBER |
|-------------------|-------------|
| All 110 to 120-13 | 110-275RP |

ITEM #8 BODY

| MODEL NUMBER | CAST IRON | STAINLESS STEEL |
|-----------------|-----------|-----------------|
| HC, 110 & 112 | 110-226RP | 110-226SRP |
| HDH & 111 | 111-004RP | 111-004SRP |
| 113 | 113-001RP | 113-001SRP |
| 120-6 to 120-13 | 120-083RP | 120-083SRP |

ITEM #31 MOTOR ASSEMBLY

| MODEL NUMBER | PART NUMBER |
|----------------|-------------|
| HC, 110 & 117 | 110-223RP |
| HDH, 111 & 113 | 110-185RP |
| 112 | 112-074RP |
| All 120 | 120-105RP |

ITEM #25 IMPELLER & SHAFT

| MODEL NUMBER | PART NUMBER |
|-----------------|-------------|
| HC & 110 | 110-207RP |
| HDH & 111 | 111-053RP |
| 112 | 112-055RP |
| 113 | 113-009RP |
| 120-6 to 120-13 | 120-038RP |

ITEM #56 COUPLER

| MODEL NUMBER | PART NUMBER |
|-------------------|-------------|
| All 110 to 120-13 | 110-009RP |

ITEM #74 BRACKET ASSY.

| MODEL NO. | CAST IRON | BRONZE | STAINLESS |
|-----------------|-----------|------------|-----------|
| HC, 110 & 117 | 110-361RP | 110-362BRP | N/A |
| HDH & 111 | 111-058RP | 111-059RP | N/A |
| 112 | 112-120RP | 112-103BRP | N/A |
| 113 | 113-013RP | N/A | 113-012RP |
| 120-6 to 120-12 | 120-067RP | N/A | 120-068RP |
| 120-13 | 120-067RP | N/A | 120-068RP |

| ITEM #113 FLANGE GASKET SET | |
|-----------------------------|-------------|
| MODEL NUMBER | PART NUMBER |
| Flat Red Rubber | 110-023RP |
| Round Cork (Thick) | 110-227RP |
| 110 to 113 | 110-339RP |
| 120-1 to 120-5 | 120-008RP |
| 120-6 to 120-13 | 1600-169RP |

| ITEM #36 FLANGE SET | | |
|---------------------|------------|------------|
| MODEL NUMBER | CAST IRON | BRONZE |
| 120-6 to 120-13 | 1600-032RP | 1600-032RP |

| MOTOR ASSEMBLY L/MOTOR | |
|------------------------|-------------|
| MODEL NUMBER & HP | PART NUMBER |
| 110 (1/12 HP) | 110-082RP |
| 111 & 113 (1/8 HP) | 110-008RP |
| 112 (1/3 HP) | 110-042RP |
| 120 (1/6 HP) | 110-008RP |

| ITEM #161 GASKET KIT | |
|----------------------|-------------|
| MODEL NUMBER | PART NUMBER |
| 110 to 113 | 110-127RP |
| 120 | 120-073RP |

ITEM –

Flange Set ¾", 1", 1¼", & 1½" Interchangeable.

Refer to Price Sheets 103-003.

For 120 models with 2 holes, specify 1600-032BRP for Bronze, 1600-032RP for Cast Iron.

Taco Comfort Solutions™ A Taco Group Company

Taco, Inc., 1160 Cranston Street, Cranston, RI 02920 | Tel: (401) 942-8000 | FAX: (401) 942-2360

Taco (Canada), Ltd., 8450 Lawson Road, Suite #3, Milton, Ontario L9T 0J8 | Tel: (905) 564-9422 | FAX: (905) 564-9436

Visit our web site: www.TacoComfort.com | Printed in USA | ©2015 Taco, Inc.

