



Submittal Data Information

101-133

Variable Speed Delta-T 00[®] Circulator

Effective: September 11, 2009

Supersedes: New

Job: _____ Engineer: _____ Contractor: _____ Rep: _____

ITEM NO.	MODEL NO.

Pump Dimensions & Weights

Model	Casing	A		B		C		D		E		F		Ship Wt.	
		in.	mm	in.	mm	in.	mm	in.	mm	in.	mm	in.	mm	lbs.	Kg
008-VDTF6	Cast Iron	5-15/16	151	4-1/2	114	3-3/16	81	2-15/16	75	5-9/16	143	6-3/8	162	9	4.0
0012-VDTF4	Cast Iron	8-1/16	205	6-3/8	162	4-1/4	108	4	102	6-5/8	168	8-1/2	216	13	5.8
0013-VDTF3	Cast Iron	7-1/2	191	6-3/8	162	3	76	3-7/8	98	6	152	6-1/2	165	14	6.2
008-VDTSF6	Stainless Steel	6	152	4	102	3-3/16	81	2-15/16	75	5-9/16	143	6-3/8	162	8	3.6
0012-VDTSF4	Stainless Steel	8-5/8	219	6-3/8	162	4-1/4	108	4	102	6-5/8	168	8-1/2	216	12	5.4
0013-VDTSF3	Stainless Steel	7-1/2	191	6-3/8	162	3	76	3-7/8	98	6	152	6-1/2	165	14	6.2

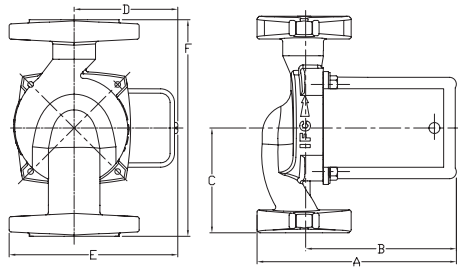

Mounting Positions

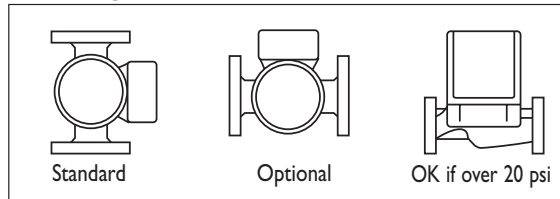

Electrical Data

Model	Volts	Hz	Ph	Amps		HP
				C.I.	S.S.	
008	115	60	1	.79	.84	1/25
0012	115	60	1	1.33	1.33	1/8
0013	115	60	1	2.0	2.0	1/6
Motor Type	Permanent Split Capacitor Impedance Protected					

Flange Orientation

