



Drop-in/Under-mount Bathroom Sink **S1201-0**

Features

- No faucet holes; requires wall- or counter-mount faucet.
- Center drain, no overflow.

Material

- Premium 20-gauge stainless steel with mirror finish.

Installation

- Drop-in or undermount.

Recommended Products/Accessories

- K-23726 Drain treatment
- K-23729 Stainless steel cleaner

Included Components

Product consists of:

- 1069536 Mounting hardware for undermount installation



Codes/Standards

None Applicable

STERLING® Warranty - Stainless Steel Sinks

See website for detailed warranty information.

Available Colors/Finishes

Color tiles intended for reference only.

Color	Code	Description
-------	------	-------------

	N/A	
--	-----	--

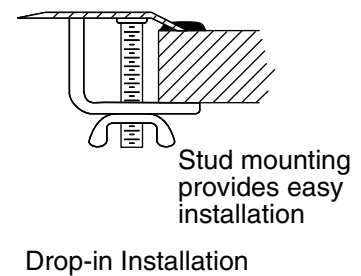
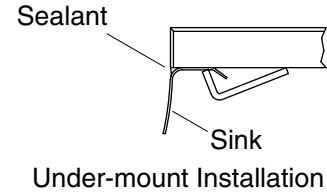
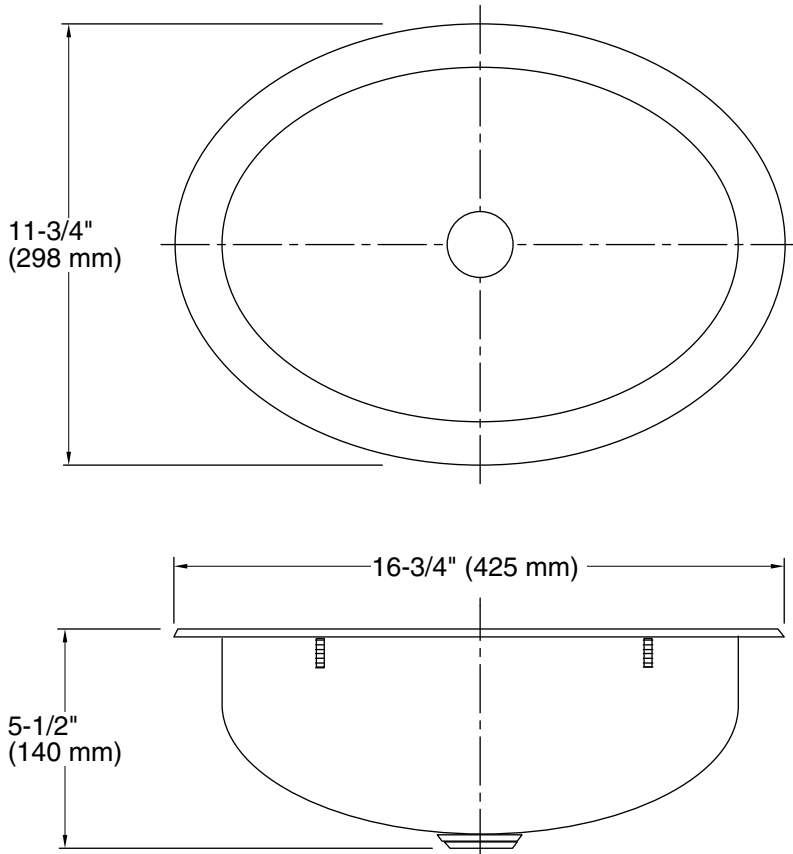

Technical Information

All product dimensions are nominal.

Bowl configuration:	Single
Installation:	Drop-in, Under-mount
Bowl area (Only):	Length: 14-11/16" (373 mm) Width: 9-11/16" (246 mm) Water depth: 4-1/2" (114 mm)
Drain hole:	1-1/2" (38 mm)
Template:	1033124-7, required, included

Notes

Install this product according to the installation instructions.

Measure your actual product for roughing-in details.