



Unwind™

59" x 30" seamless rectangle bath

96135

Features

- Freestanding design creates a striking focal point in your bathing area.
- Rectangle shape allows for corner, back-to-wall, or traditional freestanding installation.
- Center toe-tap drain.
- Integral lumbar support on both ends.
- Built-in integral overflow.
- 4.5" drain-to-floor clearance for above-floor drain installation.

Material

- Acrylic.

Installation

- Freestanding.
- Above-floor drain (AFD) rough-in.
- Concealed adjustable legs make leveling during installation easy.

Included Components

Additional Components:
1381626-0

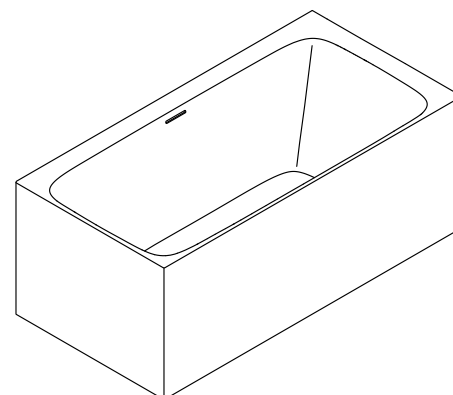

Codes/Standards

CSA B45.5/IAPMO Z124
ASTM E162
ASTM E662

Warranty – Bathing Fixtures (and) Kitchen and Utility Sinks Made of Solid Vikrell® Material

See website for detailed warranty information.

Available Colors/Finishes

Color tiles intended for reference only.

Color	Code	Description
-------	------	-------------

	0	White
-------------------------------------------------------------------------------------	---	-------

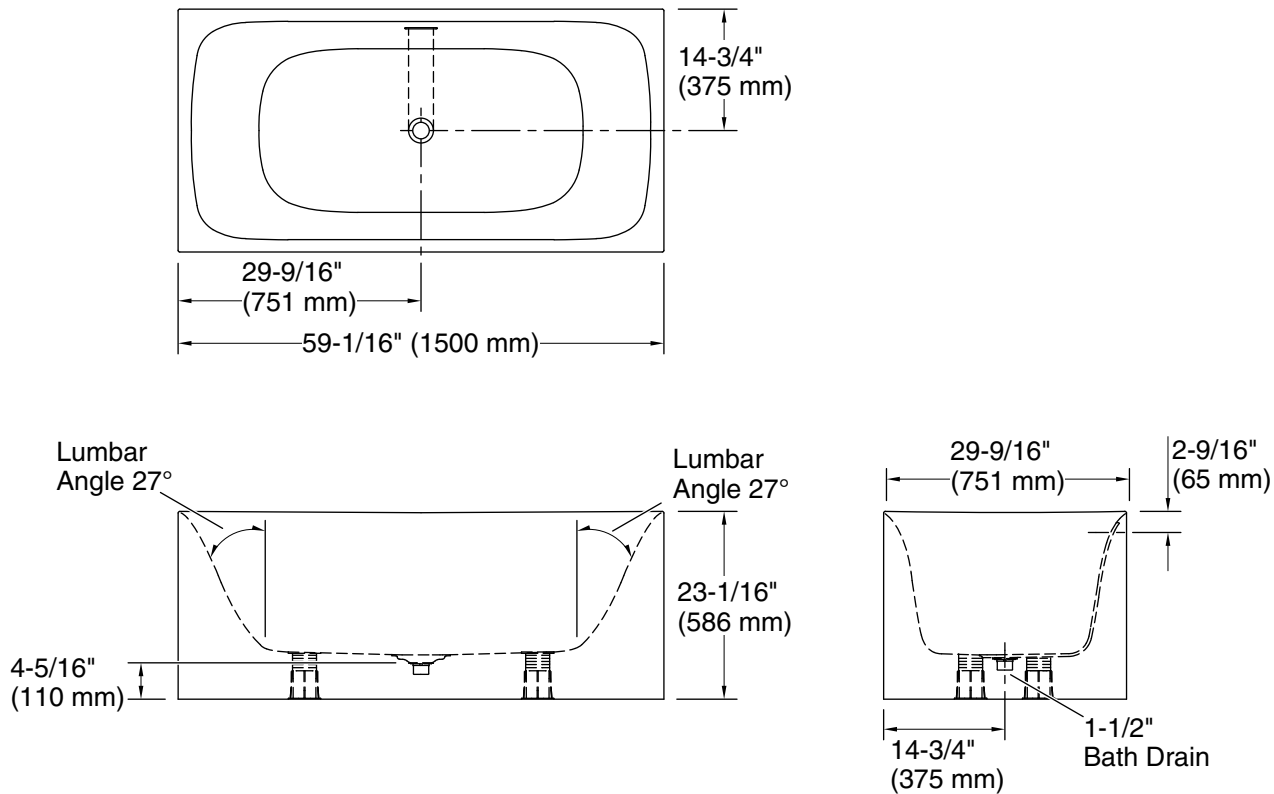

Technical Information

All product dimensions are nominal.

Installation:	Freestanding
Drain location:	Center
Basin area, bottom:	40-5/8" x 20-1/4" (1031 mm x 514 mm)
Basin area, top:	55-3/16" x 25-1/16" (1401 mm x 637 mm)
Water depth:	14-5/8" (371 mm)
Water capacity:	60 gal (227.1 L)

Notes

Install this product according to the installation instructions.

Measure your actual product for roughing-in details.

The hot water supply should be 70% of the capacity of the bath or greater. Installations will vary.

Do not support the load weight of the bath by the rim.