

**CODE NUMBER**

0326045PK

**DESCRIPTION**

Thermostatic mixing valve supplied with Sloan Optima<sup>®</sup> and Optima Plus<sup>®</sup> faucets that are specified with the "BDT" (Below Deck Thermostatic) variation, or available separately.

**FEATURES**

**MIX-135-A Thermostatic Water Mixing Valve with the following features:**

- • Designed for under-the-lavatory applications where the outlet temperature of hot water must be controlled for safe, economic use.
- • Installs in place of the Tee fitting supplied with the faucet prior to the solenoid valve
- • Designed to quickly sense and compensate for temperature fluctuations induced by water temperature and pressure changes in the supply line
- • Rugged construction features solid brass valve body and corrosion resistant internal components
- • Water temperature adjustment stem with lock nut to prevent tampering
- • Equipped with integral check valves at inlets
- • 3/8" compression connection on inlets and outlet
- • Meets all the performance standards of ASSE 1070 and CSA B125
- • Capacity — standard: .....4.0 gpm (15.0 Lpm) †
- • Maximum Hot Water Supply Temperature:.....180° F (82° C)
- • Minimum Hot Water Supply Temperature:.....5° F (2.8° C) above set point
- • Maximum Operating Pressure: .....125 psig (862kPa)
- • Minimum flow — standard:.....0.25 gpm (1.0 Lpm) to ASSE 1016
- • Factory set: .....105° F (40° C)
- • † At 45 PSI differential (310 kPa), with hot water supply between 140°-180° F (60°-82° C).

**NOTES**

All information contained within this document subject to change without notice.

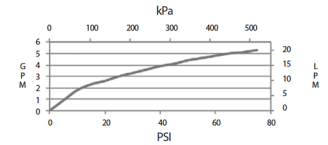
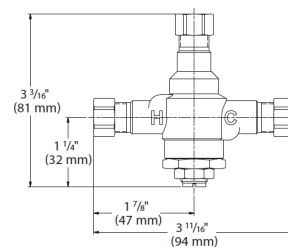

**COMPLIANCES & CERTIFICATIONS**



(UPC Low Lead Compliant, ASSE 1070)