

ADJUSTABLE HUB DRAIN FIXTURE

» 832 SERIES

FinishLine™

ITEM # SUBMITTED	_____
JOB NAME	_____
LOCATION	_____
ENGINEER	_____
CONTRACTOR	_____
PO#	_____ TAG _____

SPECIFICATION

Sioux Chief 832 Series FinishLine adjustable hub drain fixture shall be used where necessary in drainage systems. Drain fixture shall allow adjustment after the concrete pour. Drain fixture shall have properly sized ACME threads for assembly into Coring Sleeve of FinishLine rough-in fixture after removal of Coring Plug.

MATERIALS

ACME-thread fixture base: ABS

Hub riser: PVC

INSTALLATION

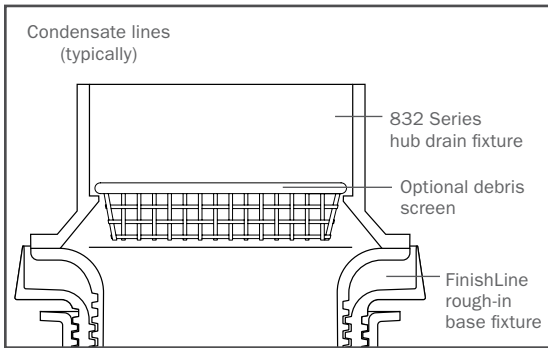

832-4HHD

DIMENSIONS

	-3HHD	-4HHD
A: Hub riser O.D.	4"	4 ⁷ / ₈ "
B: Overall height	4 ³ / ₄ "	5 ¹ / ₄ "
C: Hub riser height	2 ³ / ₈ "	2 ³ / ₄ "

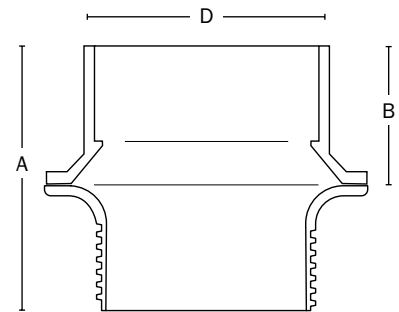

Create Item Number

832-A

e.g. **832-4HHD:** Large model adjustable hub drain fixture for FinishLine system

CONNECTION TYPE A

3HHD = Smaller model for 5¹/₂" Coring Sleeve

4HHD = Smaller model for 6¹/₂" Coring Sleeve

ACCESSORIES (ordered separately)

832-UM = Stainless steel mesh debris basket¹

¹ For use with 832-4HHD model only