

SUBMITTAL DATA SHEET

NL Service Fitting – 74753-33

-33 PEP Compression x MNPT

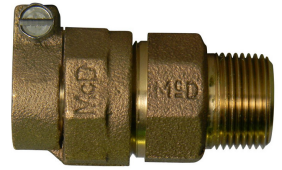

MODEL	SIZE	A	B	C	D	E
74753-33	3/4	2.03	3/4	3/4	OCT	1.38
74753-33	3/4 X 1	2.44	3/4	1	OCT	1.38
74753-33	1	2.76	1	1	OCT	1.85
74753-33	1 X 3/4	2.50	1	3/4	OCT	1.85
74753-33	1 X 1 1/2	2.69	1	1 1/2	HEX	1.69
74753-33	1 1/4	2.60	1 1/4	1 1/4	OCT	2.06
74753-33	1 1/4 X 1	2.60	1 1/4	1	OCT	2.10
74753-33	1 1/4 X 1 1/2	2.67	1 1/4	1 1/2	OCT	2.25
74753-33	1 1/2	2.70	1 1/2	1 1/2	OCT	2.44
74753-33	2	2.96	2	2	OCT	3.09
74753-33	2 X 1	2.96	2	1	OCT	3.05

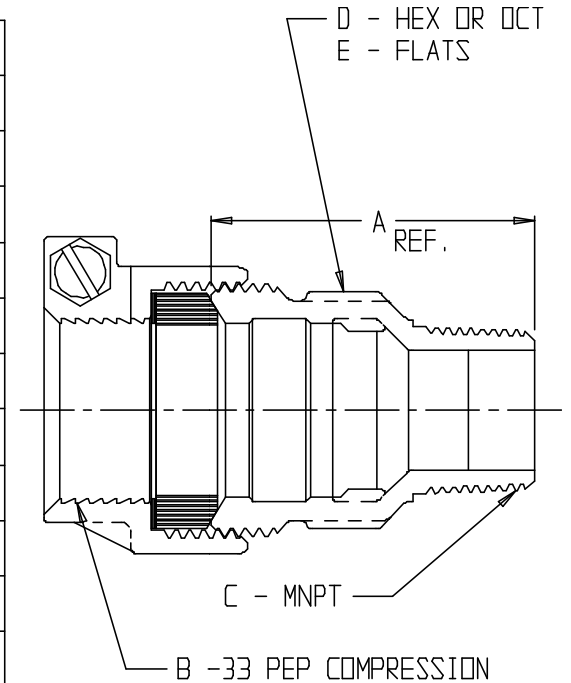

SUBMITTAL INFORMATION

- Manufactured in compliance with ANSI/AWWA C800 (latest revision)
- Brass components in contact with potable water conform to ASTM B584, UNS C89833 (latest revision) and identified with "NL"
- Certified to NSF/ANSI 61 and NSF/ANSI 372
- Brass components not in contact with potable water conform to ASTM B62 and ASTM B584, UNS C83600 -85-5-5-5 (latest revision)
- Large wrench flats provided for proper installation
- Insert stiffeners required on all flexible plastic connections



A.Y. McDonald Mfg. Co.
P.O. Box 508
Dubuque, IA 52004-508

Toll Free: 1-800-292-2737
Fax: 1-800-832-9296
Hours: 7:00 a.m. – 5:00 p.m., CST

sales@aymcdonald.com
www.aymcdonald.com

A.Y. McDonald considers the information on this assembly drawing correct when published. Item and option availability, including specifications, are subject to change without notice.

Submitted by:

09-14