

SUBMITTAL SHEET

JOB NAME	ITEM TAG
JOB LOCATION	PART NUMBER
CONTRACTOR	DATE
ENGINEER APPROVAL	DATE

PACK JOINT X FIP COUPLING CTS X FIP

Model T-4305

Conforms to A.W.W.A. Specifications

C800 underground service line

Valves and fittings)

Working Pressure, Non Shock (PSI)

Cold working pressure (CWP): 100 PSI 3/4"-1", 80 PSI 1 1/4"-2"

Pictured
Model T-4305

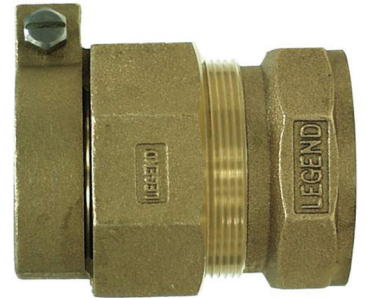

Pictured
Model T-4305
Cut-away

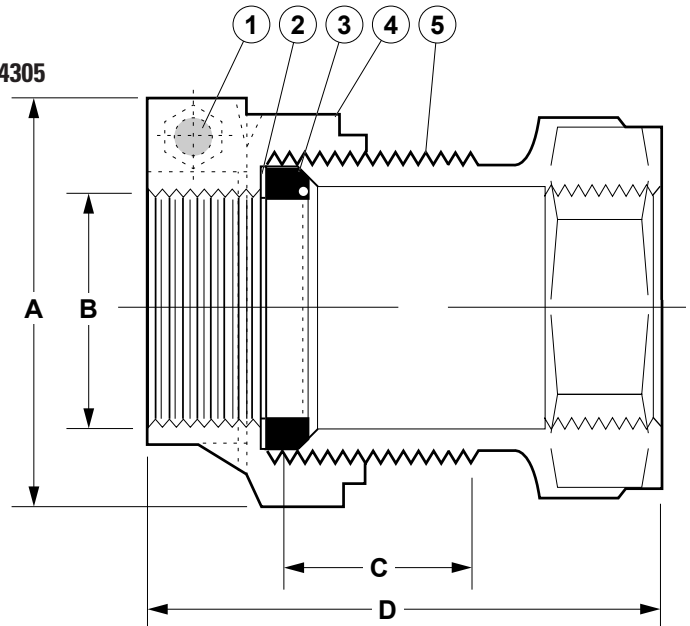

MATERIAL SPECIFICATION			
PART	MATERIAL	SPECIFICATION	
1	Split clamp screw	Stainless steel	304
2	Anti-friction ring	Nylon	Commercial grade
3	Gasket	Buna-n	Commercial grade
4	Cts nut	Bronze	ASTM B62 UNS C83600
5	Body	Bronze	ASTM B62 UNS C83600/C84836

DIMENSIONS				
Size	A	B	C	D
3/4"	1.55	.91	.59	2.50
1"	1.85	1.16	.53	2.50
1 x 3/4"	1.85	1.16	.59	2.50
1-1/4"	2.42	1.40	.62	2.91
1-1/2"	2.42	1.65	.52	3.56
2"	2.95	2.15	.68	4.83