



**Vault™**  
Top-/Under-Mount Bar Sink  
**K-3840-3**

**Features**

- 18-inch minimum base cabinet width.
- Single bowl.
- 9" (229 mm) depth provides generous workspace.
- Three faucet holes.
- Includes installation hardware and bottom sink rack.
- Three-hole faucet drilling.

**Material**

- Handcrafted from 18-gauge stainless steel.
- Premium 18-gauge stainless steel.

**Installation**

- Top-mount or undermount.

**Recommended Products/Accessories**

K-8801 Sink Strainer  
K-8799 Sink Strainer  
K-23726 Drain treatment  
K-23729 Stainless steel cleaner

**Optional Products/Accessories**

1177161 Installation Clip Kit  
K-11352 Disposal Flange with Stopper

**Included Components**

Product consists of:

K-2993 Sink Rack

Additional Components:

Cut-out template

Hardware kit – top-mount



**ADA**

**Codes/Standards**

ASME A112.19.3/CSA B45.4

ADA

ICC/ANSI A117.1

**Lifetime Limited Warranty for  
KOHLER® Stainless Steel Sinks**

See website for detailed warranty information.

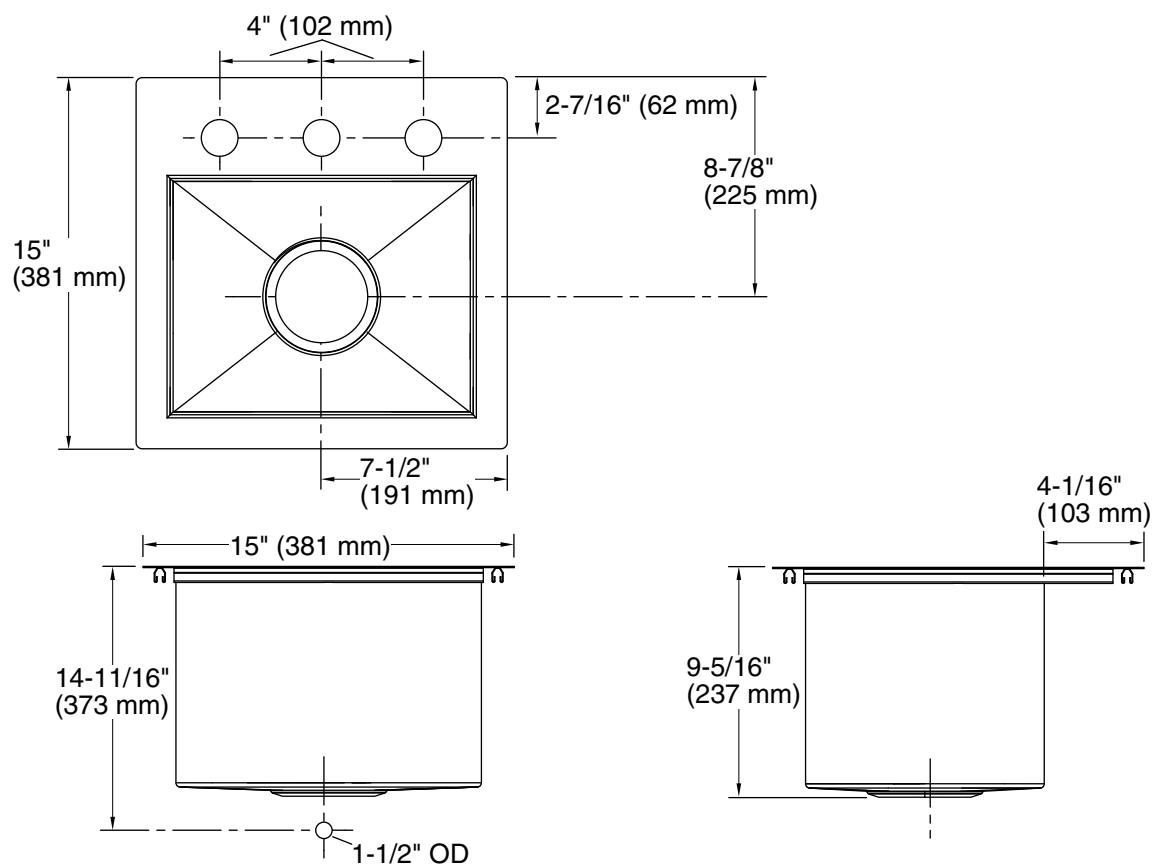

## Technical Information

All product dimensions are nominal.

Bowl configuration:	Single
Installation:	Top-mount, Under-mount
Min. base cabinet width:	18" (457 mm)
Bowl area (Only):	Length: 12-1/4" (311 mm) Width: 9-9/16" (243 mm) Bowl depth: 9" (229 mm)
Number of deck holes:	3
Faucet hole(s):	1-7/16" (37 mm)
Drain hole:	3-5/8" (92 mm)
Template:	1161548-7, required, included

## Notes

Install this product according to the installation instructions.

ADA compliant when installed to the specific requirements of these regulations.

ADA permits a parallel approach to wet bars.