

Features

- Rounded glass shade joins pristinely with its decorative mount, creating an elegant simplicity
- A great piece for almost any space — master bathroom, guest bathroom, hallway, or bedside
- Integrated LED
- Suitable for damp locations, per UL 1598
- Includes installation hardware
- Coordinates with other products in the Crue collection

Material

- Manufactured with quality materials and complemented with a meticulous finishing process
- Durable finishes engineered to last and designed to coordinate with KOHLER faucet finishes

Installation

- Requires a 4" W (102 mm) x 1-1/2" D (38 mm) octagonal electrical outlet box



Codes/Standards

California Energy Commission (CEC)
UL 1598
CSA C22.2 No. 250.0
CA Title 24 JA8

KOHLER® Indoor Lighting Fixtures Limited Warranty

See website for detailed warranty information.

Available Colors/Finishes

Color tiles intended for reference only.

| Color | Code | Description |
|---|------|-----------------------|
|  | TTL | Titanium |
|  | BNL | Brushed Nickel |
|  | CPL | Polished Chrome |
|  | BLL | Matte Black |
|  | 2GL | Brushed Moderne Brass |

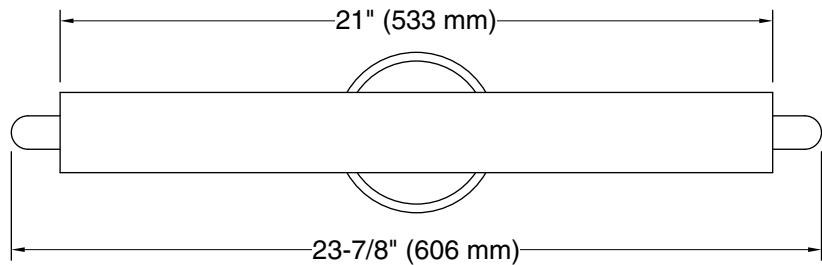
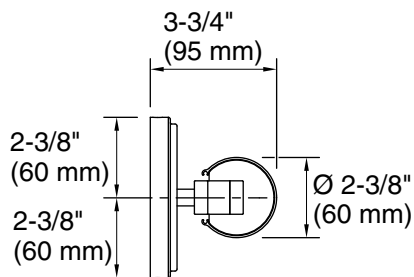

Technical Information

All product dimensions are nominal.

Material: Polymer, Steel, Aluminum
Lighting Type: Integrated LED
Socket Type: LED Integrate
Number of Shades: 1
Shade Type: Frosted Plastic
Hanging Type: Non-hanging
Electrical component rating: LED: 60 Hz, 23 W, 2087 Lumens

Notes

Install this product according to the installation instructions.