

Cutters & Accessories

For 3/8", 1/2" and 9/16" Cables



AH
Arrow Head



BG
Boring Gimlet



RTR-1
Small Corkscrew
Retrieving Tool



2SCB, 3SCB and 4SCB
2", 3", and 4"
Side Cutter Blades



2UC
2" U-Cutter



1-1/2 UC
1-1/2" U-Cutter

For 5/8" and 3/4" Cables



SHD
Spear Head



UC
2", 3", and 4"
U-Cutters



**3HDSC
4HDSC**
3" and 4"
Heavy Duty Side Cutters



**2SCB,
3SCB,
4SCB**
2", 3",
and 4" Side Cutter Blades



**3RSB
4RSB**
3" and 4" Rotary Saw Blades



**3HDB
4HDB**
3" and 4" Heavy Duty
Saw Blades



RTR-2
Corkscrew
Retrieving Tool



RP-2
Root Ripper™



CG ClogChopper®
1", 1-1/2", 2",
2-1/2", 3" and 4"



**DUC
DHDSC**
3" and 4" Spider Cutter™

Model 88 Standard Cutter Set



G-SHD
Spear Head



G-2UC
2" U-Cutter



G-3HDSC
3" Heavy Duty Side Cutter



G-4RSB
4" Rotary Saw Blade



G-RTR-2
Retrieving Tool



CW
Coupling Wrench
(Fits both "G" and "L" connectors.)



G-HA
Hook Auger



G-3HDB
3" Heavy Duty Saw Blade

Model 88 Accessories



G-CA
Cutter Adapter
Converts all cutters above
for use with "G" connectors.



CC
Cable Carrier
Holds five 10-ft. sections.s.



WCC
Wheeled Cable Carrier
Holds five 10-ft. sections.s.



G-FSH
Flex-Spear
Good in 4" "P" traps.



G-CL
Cutter Leader
Adds flexibility to front of Proflex cables.



CF
Cable Feeding Tool (Standard with Model 88)
Helps work cable around tight bends.

Connectors



QF – “Quick- Fix”
Just screw on tightly and it won't come off. For 1/2", 9/16", 5/8" and 3/4" cables.



RS – Repair Sleeve
In 3/8", 1/2", 5/8", and 3/4" sizes.(weld on)



FC-O – Female Connectors
3/8", 1/2", 5/8", and 3/4" sizes. (weld on)

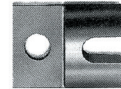

MC-O – Male Connectors
3/8", 1/2", 5/8", and 3/4" sizes. (weld on)



Snake Oil™
It protects your cables better than common lubricants. Its special rust inhibitor cuts through moisture and replaces it with a rust-resistant coating. In addition, Snake-Oil gives your equipment a fresh, clean smell. Available in quarts and gallons.

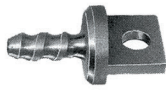
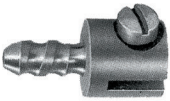

Screw-in Connectors and Splicers
5/8" and 3/4"
(Wire rope center must be removed with 1/8" drill bit rotating at very slow speed.)

Cables

Sectional Cables

Quick coupling “Cable Saver” sectional cables for the Model 88. Choose from two coupling styles. Both snap together in a second and are taken apart quickly with a spanner wrench or even a screwdriver. With the more recently developed “G” connector, no torque is put on the locking pin when running in reverse, making it a very durable coupling

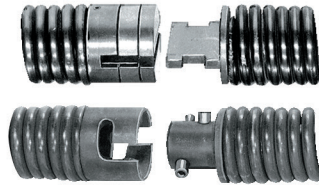

Heavy Duty Proflex™ Sections

Same 1-1/4" outer spring as the Proflex but with a 5/8" heavy duty inner spring to provide more torque for difficult stoppages and longer runs. Available in 10 foot sections with “G” or “L” connectors.

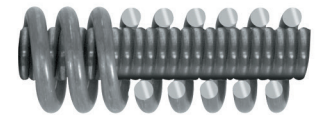

6 ft. x 7/8" Proflex™ Sections (Cat # 6L78)

For 2" to 4" drain lines up to 100 ft. long. It combines a 6 ft. x 7/8" outer cable with 7/16" Proflex inner spring giving you the flexibility to get through small lines with the strength to resist kinking. For use with the Model 88 using the 78L-CDC Drive Coupling or the 78L-AD Adapter. Available with “L” connector.



Flexichain™ Sections

1-1/4" outer spring wrapped around a chain center gives unmatched flexibility to get through tight traps and difficult bends, while providing maximum protection against losing broken cables in a line. Outer spring is right-hand wound for faster feeding. Available in 8 and 10 ft. lengths with “G” or “L” connectors.



Proflex™ Sections

Combination of 1-1/4" outer spring with 1/2" Proflex inner spring to better handle motor torque and have better “push” when working through tough stoppages. Outer spring is right-hand wound and inner spring is left-hand wound for greater strength and durability. Available in 4, 8 or 10 foot sections with “G” or “L” connectors.



Flexicore® Cable

Wire Rope Center Construction
Heavy-gauge wire coiled tightly around 49-strand aircraft-type wire rope and heat treated. Has unequalled strength and the right amount of flexibility. So tough it carries a one-year warranty against defect or breakage.

Flexicore Patent Nos.
2,244,735 and 2,849,870

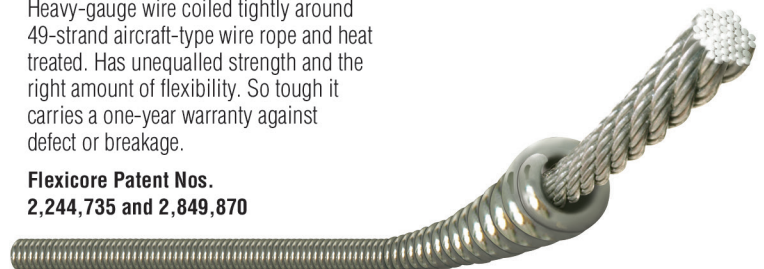

General General Wire Spring Co.
PIPE CLEANERS
McKees Rocks, PA 15136 USA
800-245-6200 or 412-771-6300