

Paiova Bathtub # 700212000000090

< 66 7/8" Inch >

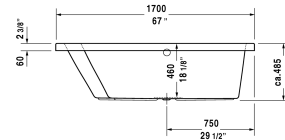
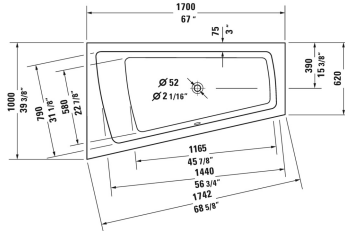

Bathtub	Dimension	Weight	Order number
with one backrest slope left, cUPC® listed*, Sanitary acrylic , Filling capacity 48 gal			
Colors			
00 White			
Variant			
drop-in or undermount, incl. support frame, Base tub	66 7/8" x 39 3/8" Inch	68.3 lb	700212000000090
Infobox			
* Complies with the following standards: CSA B45.5/IAPMO Z124			
Suitable products			
Tile flange ,			790112
Cable-driven waste and overflow ,			790219
Bathtub anchors for mounting and support of bathtubs and shower trays, 3 pieces,			790103
Headrest for Paiova, material: polyurethane, White,			790001
Support frame (included), for bathtubs,			790133
Waste and overflow brass, Chrome trim,			791255

All drawings contain the necessary measurements which are subject to standard tolerances. They are stated in inch & mm and are non-binding. Exact measurements, in particular for customized installation scenarios, can only be taken from the finished ceramic piece.