

PRODUCT SUBMITTAL 911

SDR11 MPT/ Dual Adapters

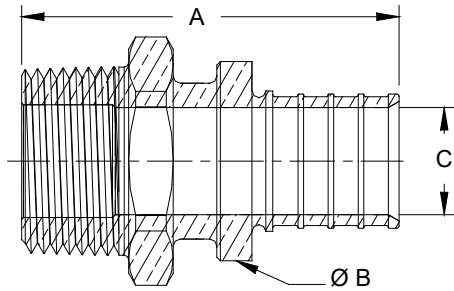

Product: SDR11 MPT/Dual Adapters
Date: 28 March 2023 (supersedes 01 January 2018)



| Article no. | Nominal size | A in (mm) | B in (mm) | C in (mm) |
|-------------|----------------------------------------------------------|------------------|------------------|-----------------|
| 298246-001 | 25mm SDR11 x 1 in. MPT or 3/4 in. C female adapter | 2.464 (62) | 1.191 (30.5) | 0.705 (17.8) |
| 242517-001 | 32mm SDR11 x 1 in. MPT adapter | 2.720 (68.5) | 1.565 (40.0) | 0.886 (22.4) |
| 235117-001 | 32mm SDR11 x 1 1/4 in. MPT or 1 in. C female adapter | 2.760 (69.5) | 1.565 (40.0) | 0.886 (22.4) |
| 242527-001 | 40mm SDR11 x 1 1/4 in. MPT adapter | 3.038 (76.5) | 1.909 (49.0) | 1.093 (27.5) |
| 235127-001 | 40mm SDR11 x 1 1/2 in. MPT or 1 1/4 in. C female adapter | 3.094 (77.9) | 1.909 (49.0) | 1.093 (27.5) |
| 242537-001 | 50mm SDR11 x 1 1/2 in. MPT adapter | 3.448 (86.9) | 2.382 (61.0) | 1.408 (35.5) |
| 235137-001 | 50mm SDR11 x 2 in. MPT or 1 1/2 in. C female adapter | 3.550 (89.5) | 2.380 (61.0) | 1.407 (35.5) |
| 235147-001 | 63mm SDR11 x 2 in. MPT adapter | 3.965 (100.0) | 2.894 (74.0) | 1.801 (45.5) |
| 235157-001 | 63mm SDR11 x 2 1/2 in. MPT or 2 in. C female adapter | 4.447 (112.5) | 2.894 (74.0) | 1.801 (45.5) |
| 242557-001 | 75mm SDR11 x 2 1/2 in. MPT adapter | 4.499 (113.9) | 3.524 (90.0) | 2.146 (54.0) |
| 235167-001 | 75mm SDR11 x 3 in. MPT or 2 1/2 in. C female adapter | 4.646 (118.0) | 3.524 (90.0) | 2.146 (54.0) |
| 235177-001 | 90mm SDR11 x 3 in. MPT or 2 1/2 in. C female adapter | 4.642 (117.9) | 4.230 (108.0) | 2.737 (69.0) |
| 235187-001 | 110mm SDR11 x 4 in. MPT or 3 1/2 in. C female adapter | 4.844 (122.8) | 5.100 (130.0) | 3.287 (83.0) |
| 235197-001 | 125mm SDR11 x 5 in. MPT adapter | 5.551 (141.0) | 5.710 (145.0) | 3.563 (90.0) |

For updates to this publication, visit na.rehau.com/resourcecenter

The information contained herein is believed to be reliable, but no representations, guarantees or warranties of any kind are made as to its accuracy, suitability for particular applications or the results to be obtained therefrom. Before using, the user will determine suitability of the information for user's intended use and shall assume all risk and liability in connection therewith.

© 2023 REHAU

PRODUCT SUBMITTAL 911

SDR11 MPT/ Dual Adapters



TECHNICAL DESCRIPTION

| | |
|----------|----------------------------------------------------------------------------|
| Material | Machined from solid brass rod (25 to 63 mm) or solid bronze (75 to 125 mm) |
|----------|----------------------------------------------------------------------------|

FUNCTIONAL DESCRIPTION

SDR11 compression-sleeve fittings are intended for heating, snow and ice melting and hydronic distribution, when used with RAUPEX® PEXa pipes. Dual adapter fittings connect RAUPEX pipe to other threaded piping systems (first size) or copper pipe (second size). Make threaded or solder connection before connecting to RAUPEX pipe. REHAU recommends threaded connections to be accessible for periodic inspection.

Installation is performed with SDR11 compression-sleeve tools. Tapered end of sleeve installs toward fitting. Follow all published installation instructions. Not certified for potable water.

For updates to this publication, visit na.rehau.com/resourcecenter

The information contained herein is believed to be reliable, but no representations, guarantees or warranties of any kind are made as to its accuracy, suitability for particular applications or the results to be obtained therefrom. Before using, the user will determine suitability of the information for user's intended use and shall assume all risk and liability in connection therewith.

© 2023 REHAU