



**Rely®**  
36" x 34" single-threshold shower base  
**K-8644**

**Features**

- Low-threshold design for easy entry and exit.
- Molded-in textured floor.
- Water containment bead incorporated into the threshold design provides an optimum barrier, preventing water from escaping from the shower space.
- Single threshold for alcove installation.
- Center drain.
- Coordinates with Choreograph® shower walls and other KOHLER® collections.

**Material**

- Acrylic.

**Recommended Products/Accessories**

K-9132 Shower Drain  
K-23726 Drain treatment  
K-23732 Tub & shower cleaner



**Codes/Standards**

CSA B45.5/IAPMO Z124  
ASTM E162  
ASTM E662





**KOHLER® Plastic Baths and  
Receptors Lifetime Limited Warranty**

See website for detailed warranty information.

**Available Colors/Finishes**

*Color tiles intended for reference only.*

**Color Code Description**

	0	White
	96	Biscuit
	NY	Dune
	95	Ice™ Grey
	G9	Sandbar

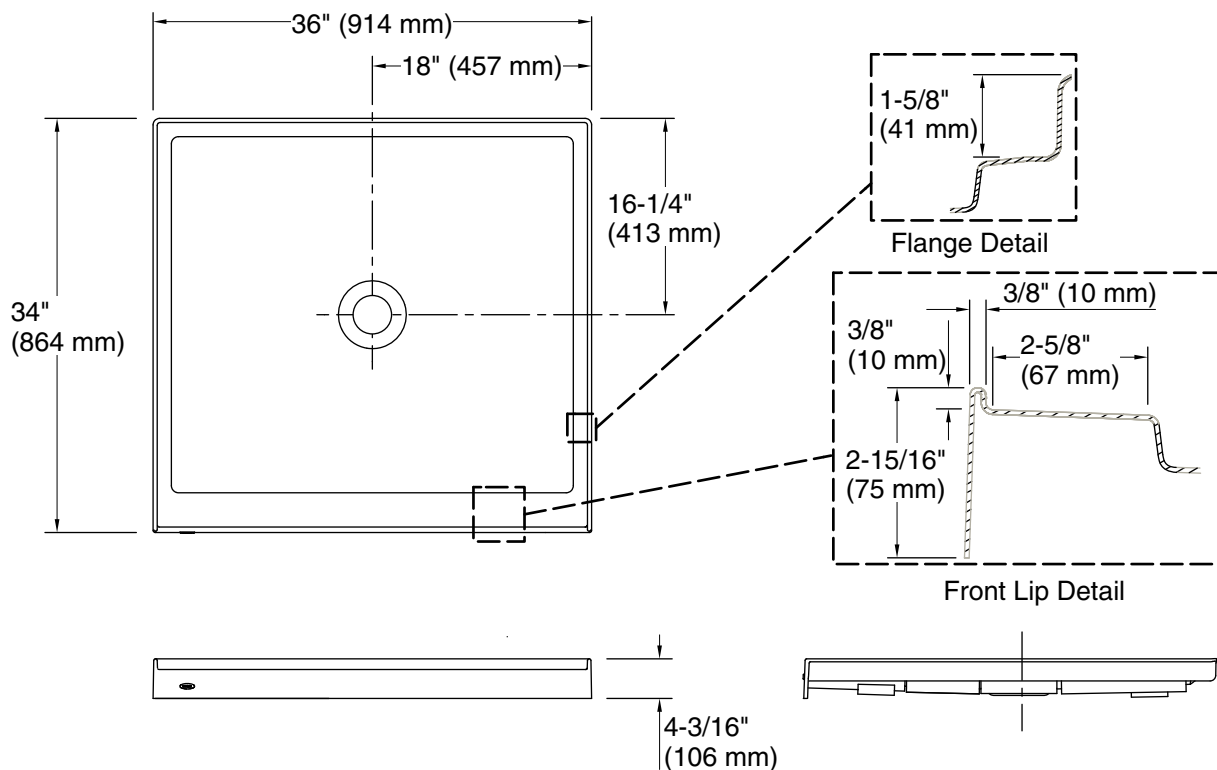

## Technical Information

All product dimensions are nominal.

Installation: Three-wall alcove  
Drain location: Center  
Weight: 34 lbs (15.4 kg)

## Notes

Measure your actual product for rough-in details.

Install this product according to the installation instructions.

Subfloor must be within 1/2" (13 mm) of level.

This receptor has a front lip. This should be taken into account when installing a shower door.