



REVOLUTION WATER HEATER

VRP-150 VRP-199
VRS-150 VRS-199

Specification Sheet

VRP / VRS Model (Tankless Water Heaters)

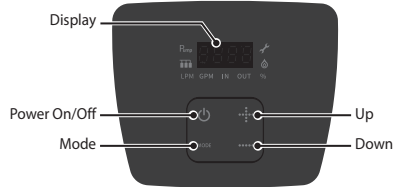
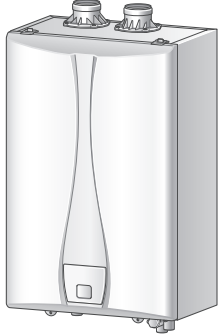

Indoor and Outdoor Venting Options

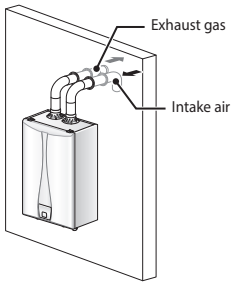

Direct Vent (Indoor)

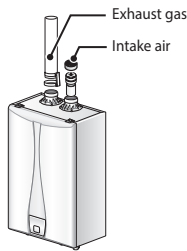

Non-Direct Vent (Indoor)

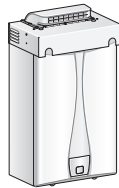

Outdoor Vent

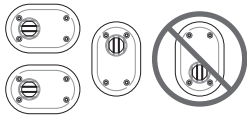

Direct Vent Termination (Indoor)

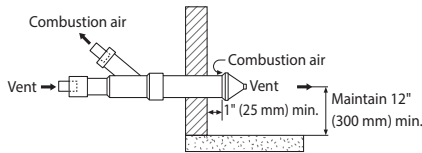

Direct Vent Concentric Termination (Indoor)

Optional accessories



Remote controller (2081182)

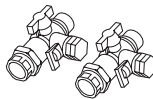

Plumb easy valve set (2040172)



Cascade communication cable (3130846)

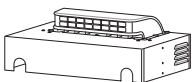

Outdoor Vent Kit (20707235)

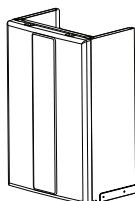

Pipe Cover (31602485)

- Certified design according to ANSI Z21.10.3 – CSA 4.3-2015 standards for both indoor or outdoor installations(with optional Outdoor Vent Kit)
- Compatible with 1/2" gas pipe up to a length of 24 ft* (*see Installation manual for additional information)
- Compatible with 2" PVC vent up to 60ft** and 150 ft** using 3"PVC vent (**with no elbows)
- Gas Input Ranges
VRP/S 150 - 150,000 to 19,900 BTUH
VRP/S 199 - 199,000 to 19,900 BTUH
- Hot Water Flow Rate Capacity (* based on 35°F temperature rise)
VRP/S 150 - 8.4 GPM
VRP/S 199 - 11.2 GPM
- High Altitude (NG/ LP) - Certified for use altitudes up to 10,100ft in accordance to the latest CAN/CGA 2.17 High Altitude Installation procedures at normal manifold pressure.
- Dual Primary and Secondary Stainless Steel Heat Exchangers for optimum efficiency and durability
- Built-in Control Panel - allows adjustment of temperature setting and displays the operating status and error codes
- VRP models come included with built-in 0.5 gallon Buffer Tank and Recirculation Pump(UPS 15-58) to provide maximum comfort
- Compatible with Grundfos Comfort valve for maximum comfort and simple installation.
- Temperature Options - available temperature settings for Residential applications range from 98°F up to 140°F with high temperature commercial mode capable of up to 182°F
- Cascade Compatible for up to 8 units for increased hot water production
- Easy installation with Cascade Racks & Customized manifolds
- Available with Wi-Fi Control
- On demand recirculation system with VST optional remote control
- Freeze Protection - maintains normal operation during freezing ambient temperatures down to -5°F (standard on all models)
- Uniform Energy Factor Ratings for NG and LP units
VRP-150 / 199 - 0.91 UEF (0.95 EF for Canada)
VRS-150 / 199 - 0.92 UEF (0.95 EF for Canada)
- Compatible with Natural Gas(NG) and Propane (LPG)*** (***)requires installation of included Field Conversion Kit by a qualified service agency)
- Approved for Installation on Mobile / Manufactured Homes
- Certified by CSA, NSF5, NSF372, AHRI, AB1953 CA Low Lead, SCAQMD (Rule 1146.2 type 1 - Complies with 14 ng/J or 20ppm Nox @ 3% O2)
- 15-Year Heat Exchanger and 5-Year Parts Warranty (Residential)
8-Year Heat Exchanger and 3-Year Parts Warranty (Commercial)



Job Name: _____

Location: _____

Engineer: _____

Wholesaler: _____

Contractor: _____

Model No.: _____

Submittes to: _____

Dimensions

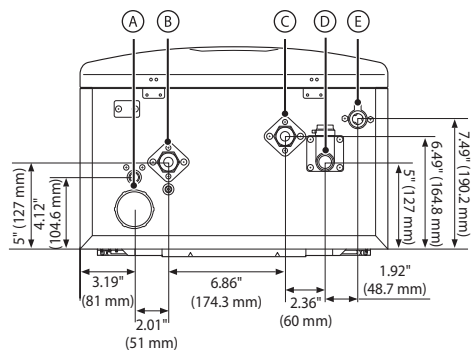
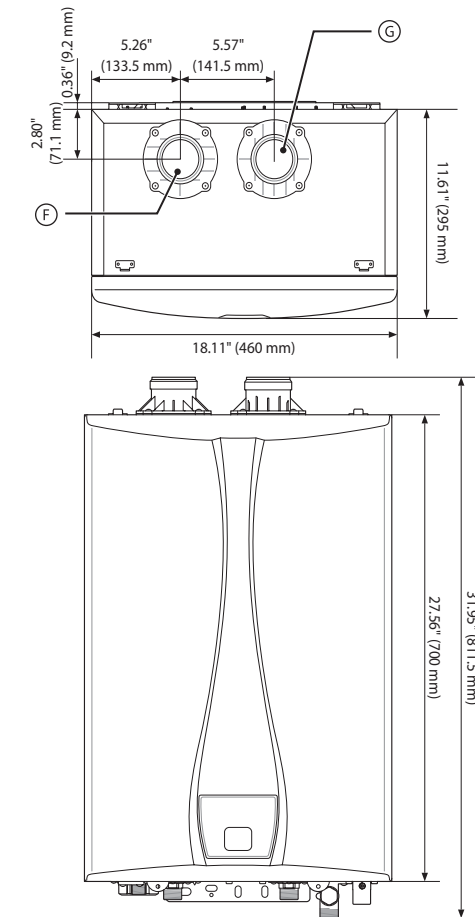

VRP Model

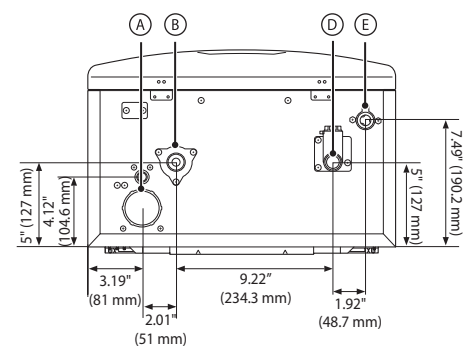

VRS Model

	Description	Diameter
(A)	Condensate outlet	1/2"
(B)	Hot water outlet	3/4"
(C)	Recirculation inlet	3/4"
(D)	Cold inlet	3/4"
(E)	Gas inlet	3/4"
(F)	Exhaust vent	2"
(G)	Air inlet	2"

Specification

item	VRP-150	VRS-150	VRP-199	VRS-199
Heat Capacity (Input)	Natural Gas	19,900–150,000 BTU/H	19,900–199,000 BTU/H	19,900–199,000 BTU/H
	Propane Gas	19,900–150,000 BTU/H	19,900–199,000 BTU/H	19,900–199,000 BTU/H
Energy Factor	Natural Gas	0.95	0.95	0.95
	Propane Gas	0.95	0.95	0.95
Flow Rate (DHW)	35°F (19°C) Temp Rise	8.4 GPM (32 LPM)	11.2 GPM (42 LPM)	
	45°F (25°C) Temp Rise	6.5 GPM (25 LPM)	8.7 GPM (33 LPM)	
	77°F (43°C) Temp Rise	3.8 GPM (14 LPM)	5.1 GPM (19 LPM)	
Dimensions (W x D x H)	18.1" x 11.6" x 27.6" (460 mm x 295 mm x 700 mm)			
Weight	75 lbs (34 kg)	67 lbs (30 kg)	75 lbs (34 kg)	67 lbs (30 kg)
Installation Type	Indoor wall-hung			
Venting Type	Forced draft direct vent			
Ignition	Electronic ignition			
Water Pressure	15–150 psi			
Natural Gas Supply Pressure	3.5"–10.5" WC			
Propane Gas Supply Pressure	8"–13" WC			
Natural Gas Manifold Pressure (Min. – Max.)	0.01" WC – –0.35" WC		0.01" WC – –0.59" WC	
High Altitude Manifold pressure	0.01" WC – –0.30" WC		0.01" WC – –0.55" WC	
Propane Gas Manifold Pressure (Min. – Max.)	0.01" WC – –0.30" WC		0.01" WC – –0.56" WC	
High Altitude Manifold pressure	0.01" WC – –0.26" WC		0.01" WC – –0.50" WC	
Minimum Flow Rate	0.1 GPM (0.4 LPM) for VRP models / 0.5 GPM (1.9 LPM) for VRS models			
Connection Sizes	Cold Water Inlet	3/4" NPT		
	Hot Water Outlet	3/4" NPT		
	Recirculation Water Inlet	3/4" NPT (Only VRP models)		
	Gas Inlet	3/4" NPT		
Power Supply	Main Supply	120V AC, 60 Hz / use less than 5 AMP		
Materials	Primary Heat Exchanger	Stainless steel		
	Secondary Heat Exchanger			
Venting	Exhaust	2" or 3" PVC, CPVC, Polypropylene 2" or 3" Special gas vent type BH (Class II, A/B/C)		
	Intake	2" or 3" PVC, CPVC, Polypropylene 2" or 3" Special gas vent type BH (Class II, A/B/C)		
	Vent Clearances	0" to combustibles		
Safety Devices	Flame rod, APS, Over heat preventer, Exhaust temperature high limit sensor, Power surge fuse			
Power Consumption	135 W	75 W	165 W	105 W

Gas-fired, tankless, condensing, wall-mounted water heater(s) shall be direct vent VRP/S models as manufactured by VESTA.DS, Inc. and are certified by CSA Group to the latest edition of ANSI standard Z21.10.3/CSA 4.3. Water heater(s) shall have a 15-year limited Heat Exchanger warranty and 5-year limited Parts warranty (8 year Heat Exchanger and 3-year Parts for Commercial use) per VESTA Limited Warranty. Unit(s) shall be designed to burn natural gas and can be for use with propane when a Field Conversion Kit is installed. Water heater(s) shall have a nominal flow rate capacity of _____ GPM/GPH at _____ °F rise with rated input of _____ BTU/hr. Water heater(s) shall be vented with 2" PVC/CPVC vent pipe at a distance not to exceed 60' (or equivalent) with each elbow equal to 8' of pipe length or 3"PVC/CPVC vent pipe at a distance of 150'(or equivalent) with each elbow equal to 5' of pipe length. Water heater(s) is rated for 150 PSI working water pressure and 300 PSI test pressure. Gas supply pressure shall be 3.5" to 10.5" WC for natural gas and 8.0" to 13.0" WC for propane. Unit(s) shall have a steel case, dual stainless steel heat exchangers, eco premixed burner, negative pressure gas valve, dual venturi, 3/4" inlet gas connection, 3/4" brass inlet/outlet water connections, water holding capacity of 0.9 gallons for the VRS models, 1.2 gallon for the VRP model, and a condensate collector. The VRS model weights 67 lbs, the VRP model weights 75 lbs. Unit(s) shall include features such as an adjustment for installations at high elevation, temperature lockout, and temperature options from 98-120°F in 2°F intervals and 120-140°F in 5°F intervals. The unit(s) shall include additional temperature options of 140-180°F in 10°F intervals for high temperature commercial applications. All VRP models shall include an internal circulation pump and 0.5 gallon buffer tank. The water heater(s) shall be controlled by an internal circuit board that monitors the inlet and outlet temperatures with installed thermistors, sensing and controlling flow rate to set point temperature with air-fuel ratio controls in order to maintain thermal combustion efficiency. Unit(s) shall include safety features such as flame sensor system, high limit sensors, overheat prevention device, freeze protection mode, and fan motor rotation detector. Cascade systems that require 2 to 8 units shall be installed by connecting the units using cable-only connections. The water heater(s) is listed by SCAQMD rule 1146.2 (Type1) for Low Nox that complies with 14ng/J or 20ppm Nox requirements @ 3% O2.

* VESTA.DS reserves the right to change specifications at any time without prior notice.