

Submittal Package

viega



Viega PureFlow® Crimp PolyAlloy Fittings

Project:

Engineer:

Contractor:

Submitted By:

Potable Water

Other _____

Submittal Package

viega

Viega PureFlow® Crimp PolyAlloy Fittings

Technical Data

Materials:

Fittings.....	PolyAlloy (Acudel® and Radel-R®)
Crimp Rings.....	Copper (black)
MANABLOC Manifolds.....	Polysulfone (plastic) PolyAlloy fittings
PureFlow Crimp Poly Manifolds.....	PolyAlloy crimp connections
Valves.....	PolyAlloy
Viega PureFlow PEX Tubing.....	PEX (crosslinked polyethylene)

Applications

Viega PureFlow Crimp Zero Lead Brass and PureFlow Crimp PolyAlloy fittings are intended for use in potable water systems. They can be directly buried in soil but shall be wrapped (fittings used in concrete shall also be wrapped). Fittings are manufactured with Viega PureFlow Crimp barbs for use with Viega PureFlow PEX tubing, crimp rings and tools.

Installation

- Use only ASTM F1807 crimp rings and approved full circle crimp tools to make connections.
- Keep flame and excessive heat away from tubing and connections.
- Refer to the Viega PureFlow Installation Manual for additional information.

“Zero Lead” identifies Viega® products meeting the lead free requirements of NSF 61-G through testing under NSF/ANSI 372 (0.25% or less maximum weighted average lead content).

Codes Approvals & Standards

ANSI/NSF 61-G

cNSF® us pw-G

CSA B137.5

U.P. Code

UPC®

ASTM F876 / F877

ASTM F1807 / F2159

ICC ES-PMG™ 1038

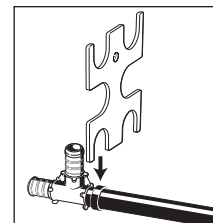
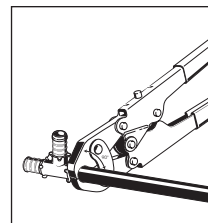
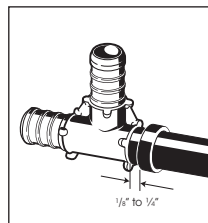

THREE SIMPLE STEPS TO A SECURE VIEGA PureFlow Crimp FITTING CONNECTION.

1. SLIDE CRIMP RING OVER END OF SQUARED OFF TUBING, FULLY INSERT FITTING INTO TUBING AND POSITION THE RING 1/8" TO 1/4" FROM THE END OF TUBING.
2. KEEP THE TOOL AT 90° AND CLOSE THE HANDLES COMPLETELY. DO NOT CRIMP TWICE.
3. CHECK CRIMP WITH GO/ NO GO GAUGE.

Submittal Package

viega



Viega PureFlow® Crimp PolyAlloy Fittings

Viega PureFlow PEX Tubing

Material.....PEX crosslinked polyethylene
Temperature/Pressure Ratings...200°F at 80 psi
 180°F at 100 psi
 73.4°F at 160 psi
Linear Expansion Rate.....1.1"/100'/10°F

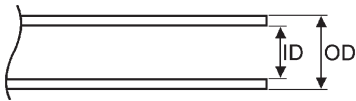

Nominal Size	Inner Diameter	Outer Diameter	Wall Thickness
3/8"	0.35	0.500±.003	0.070±.010
1/2"	0.47	0.625±.004	0.070±.010
3/4"	0.67	0.875±.004	0.097±.010
1"	0.86	1.125±.005	0.125±.013

Submittal Package

viega

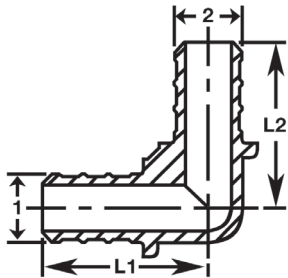

Viega PureFlow Crimp 90° Elbow Zero Lead PolyAlloy - Model V5216

Part Number	Size		L1 (in)	L2 (in)
	1	2		
43210	3/8"		1.15	1.15
43220	1/2"		1.15	1.15
43240	3/4"		1.25	1.25
43242	3/4" x 1/2"		1.25	1.25
43260	1"		1.53	1.53

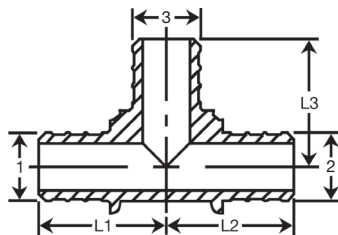

Viega PureFlow Crimp Tee Zero Lead PolyAlloy - Model V5218

Part Number	Size			L1 (in)	L2 (in)	L3 (in)
	1	2	3			
43500	3/8"			1.16	1.16	1.16
43520	1/2"			1.15	1.15	1.15
43334	1/2" x 1/2" x 3/4"			1.25	1.25	1.15
43540	3/4"			1.25	1.25	1.25
43433	3/4" x 1/2" x 1/2"			1.25	1.15	1.25
43434	3/4" x 1/2" x 3/4"			1.25	1.25	1.25
43443	3/4" x 3/4" x 1/2"			1.15	1.15	1.25
43445	3/4" x 3/4" x 1"			1.30	1.30	1.34
43544	1" x 3/4" x 3/4"			1.37	1.36	1.36
43545	1" x 3/4" x 1"			1.54	1.39	1.54
43553	1" x 1" x 1/2"			1.33	1.33	1.32
43554	1" x 1" x 3/4"			1.33	1.33	1.26
43560	1"			1.53	1.53	1.53

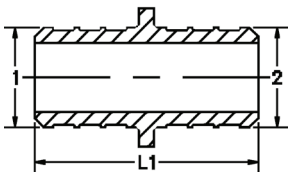

Viega PureFlow Crimp Coupling Zero Lead PolyAlloy - Model V5215

Part Number	Size		L(in)
	1	2	
43402	3/8"		1.52
43403	1/2"		1.50
43332	1/2" x 3/8"		1.52
43343	3/4" x 1/2"		1.50
43353	1" x 1/2"		1.70
43404	3/4"		1.50
43354	1" x 3/4"		1.70
43355	1"		1.82

Submittal Package

viega

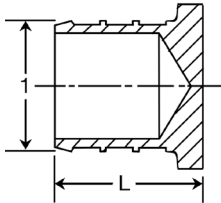

Viega PureFlow Crimp Test Plug Zero Lead PolyAlloy - Model V5058

Part Number	Size	L (in)
	1	
43702	3/8"	0.76
43723	1/2"	0.76
43744	3/4"	0.95
43765	1"	1.13

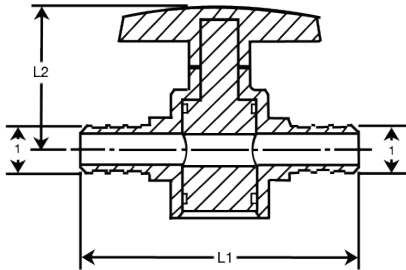

Viega PureFlow Crimp Valve Zero Lead PolyAlloy 1/4 Turn - Model V5236

Part Number	Size	L1 (in)	L2 (in)
	1		
43030	1/2"	2.83	1.45
43040	3/4"	3.00	1.45

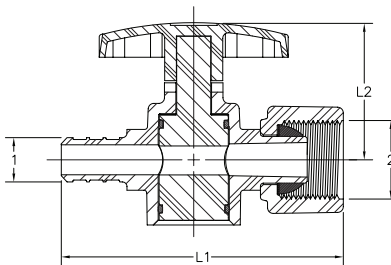

Viega PureFlow Crimp Stop Valve Straight Zero Lead PolyAlloy Crimp x Lav 1/4 Turn - Model V5036.30

Part Number	Size	L1 (in)	L2 (in)
	1 2		
43023	3/8" x 1/2" Lav	3.00	1.45
43031	1/2" x 1/2" Lav	3.00	1.45

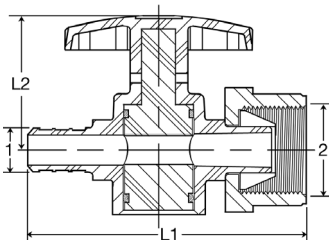

Viega PureFlow Crimp Stop Valve Straight Zero Lead PolyAlloy Crimp x Closet 1/4 Turn - Model V5036-31

Part Number	Size	L1 (in)	L2 (in)
	1 2		
43002	3/8" x 1/2" Closet	3.00	1.45
43003	1/2" x 1/2" Closet	3.00	1.45

Submittal Package

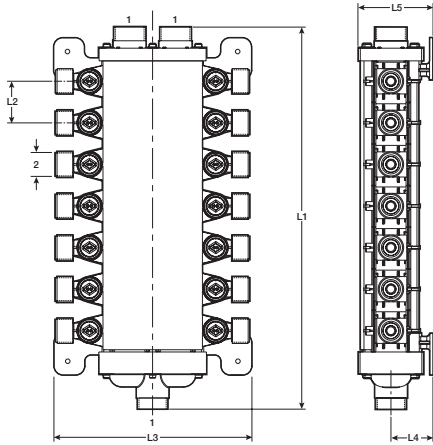

Viega ManaBloc Distribution Manifold Zero Lead Crimp - Model V5030.5

Part Number	Size		Ports	L1	L2	L3	L4	L5
	1	2						
50143	1" x 5/8" NPSM	14	15.44"	1.68"	8.00"	1.70"	3.00"	
51618	1" x 5/8" NPSM	18	18.80"	1.68"	8.00"	1.70"	3.00"	
50243	1" x 5/8" NPSM	24	23.78"	1.68"	8.00"	1.70"	3.00"	
50303	1" x 5/8" NPSM	30	28.88"	1.68"	8.00"	1.70"	3.00"	
50363	1" x 5/8" NPSM	36	33.92"	1.68"	8.00"	1.70"	3.00"	

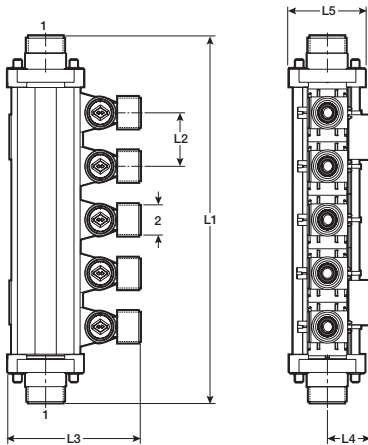

Viega MiniBloc Zoning Manifold Zero Lead Crimp - Model V5031.5

Part Number	Size		Ports	L1	L2	L3	L4	L5
	1	2						
50033	1" x 5/8" NPSM	3	8.19"	1.68"	4.37"	1.42"	2.50"	
50043	1" x 5/8" NPSM	4	9.87"	1.68"	4.37"	1.42"	2.50"	
51063*	1" x 5/8" NPSM	5	11.55"	1.68"	4.37"	1.42"	2.50"	
50063	1" x 5/8" NPSM	6	13.23"	1.68"	4.37"	1.42"	2.50"	
51073*	1" x 5/8" NPSM	7	14.91"	1.68"	4.37"	1.42"	2.50"	
50083	1" x 5/8" NPSM	8	16.59"	1.68"	4.37"	1.42"	2.50"	
51003*	1" x 5/8" NPSM	10	19.95"	1.68"	4.37"	1.42"	2.50"	

*Manifold incorporates hot and cold ports.

Submittal Package

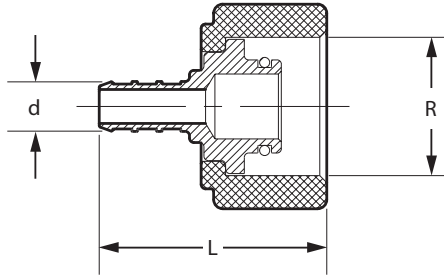

Viega PureFlow Crimp Port Adapter Zero Lead PolyAlloy for ManaBloc Crimp x Port - Model V5039.1

Part Number	Size		L (in)
	1	2	
50023	3/8" x 1/2" Port		1.58
50133	1/2" x 1/2" Port		1.58

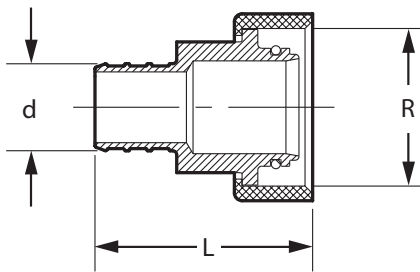

Viega PureFlow Crimp Supply Adapter Zero Lead PolyAlloy for ManaBloc Crimp x Supply - Model V5213

Part Number	Size		L (in)
	1	2	
50141	3/4" x 1" ManaBloc		1.66
50151	1" x 1" ManaBloc		1.84

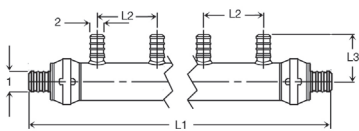

Part Number	Size		L1 (in)	L2 (in)	L3 (in)
	1	2			
65152	3/4" x 1/2" - 2 Outlet		6.50	2.00	1.55
65153	3/4" x 1/2" - 3 Outlet		8.50	2.00	1.55
65154	3/4" x 1/2" - 4 Outlet		10.50	2.00	1.55
65254	1" x 3/4" x 1/2" - 4 Outlet		10.60	2.00	1.55
65256	1" x 1/2" - 6 Outlet		14.80	2.00	1.55
65258	1" x 1/2" - 8 Outlet		18.80	2.00	1.55

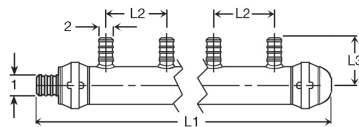

Viega PureFlow Crimp Manifold Zero Lead PolyAlloy Closed - Model V5031.22

Part Number	Size		L1 (in)	L2 (in)	L3 (in)
	1	2			
65104	3/4" x 1/2" - 4 Outlet		10.10	2.00	1.55
65206	1" x 1/2" - 6 Outlet		14.30	2.00	1.55

Submittal Package

viega

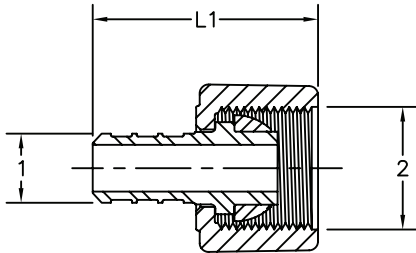

Viega PureFlow Crimp Lav Adapter Zero Lead PolyAlloy Crimp x Lav - Model V5263

Part Number	Size		L1 (in)
	1	2	
43323	3/8"	1/2" Lav	1.52
43333	1/2"	1/2" Lav	1.46
43344	3/4"	3/4" Lav	1.62

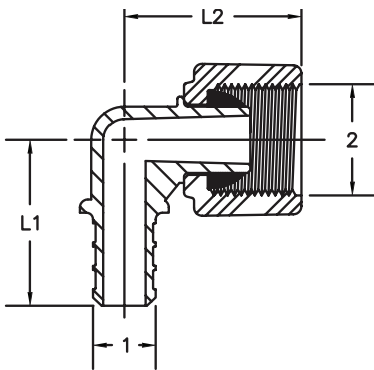

Viega PureFlow Crimp Lav Adapter 90° Elbow Zero Lead PolyAlloy Crimp x Lav - Model V5255

Part Number	Size		L1 (in)	L2 (in)
	1	2		
43232	3/8"	1/2" Lav	1.35	1.15
43233	1/2"	1/2" Lav	1.35	1.15
43244	3/4"	3/4" Lav	1.42	1.25

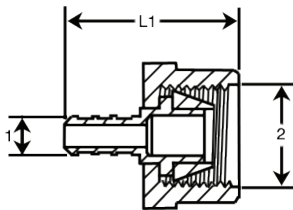

Viega PureFlow Crimp Closet Adapter Zero Lead PolyAlloy Crimp x Closet - Model V5257

Part Number	Size		L1 (in)
	1	2	
43300	3/8"	1/2" Closet	1.60
43320	1/2"	1/2" Closet	1.60

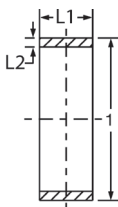

Viega PureFlow Crimp Ring Copper - Model V5019.9

Part Number	Size	L1 (in)	L2 (in)
43600	3/8" SDR9	0.32	0.05
43620	1/2" SDR9	0.32	0.05
43640	3/4" SDR9	0.32	0.05
43660	1" SDR9	0.36	0.04

Viega products are designed to be installed by licensed and trained plumbing and mechanical professionals who are familiar with Viega products and their installation. **Installation by non-professionals may void Viega LLC's warranty.**

This document is subject to updates. For the most current Viega technical literature please visit www.viega.us.

Viega LLC • 585 Interlocken Blvd. • Broomfield, CO 80021 • Phone (800) 976-9819 • www.viega.us