

SharkBite Max™

Slip Ball Valve

SharkBite Max™ allows users to connect pipe with ease - no tools needed. This new design features a stainless steel retainer for extra strength, higher pressure ratings (250 psi) and a lower insertion effort than previous versions of SharkBite Brass Push-to-Connect fittings. SharkBite Max slip ball valves are compatible with copper and CPVC.

Applications

Residential and commercial potable water, recirculation, hydronic heating/cooling (up to 50% glycol concentration) and direct burial.

Specification Data

Materials

Body	Lead-Free DZR Brass
O-ring	EPDM
Steel Retainer	304 Stainless Steel
Grab Ring	Stainless Steel
Seal Ring	PTFE
Ball	Chrome Plated Brass
Handle	Steel with PVC Coating
Lock Nut	Stainless Steel
Spindle	Lead-Free DZR Brass

Pipe Insertion Depth

Fitting Size	Insertion Depth
1/2"	1.00 in.
3/4"	1.25 in.

Performance

Max Working Pressure	
Max Pressure	400 psi
Max Temperature	200°F (93°C)

Certifications & Listings

ASME A112.4.14/CSA B125.14, NSF/ANSI 14, NSF/ANSI/CAN 61, NSF/ANSI/CAN 372

For listing information, please contact Customer Service

* HDPE installations must use a tube stiffener. Sold separately by HDPE manufacturer.

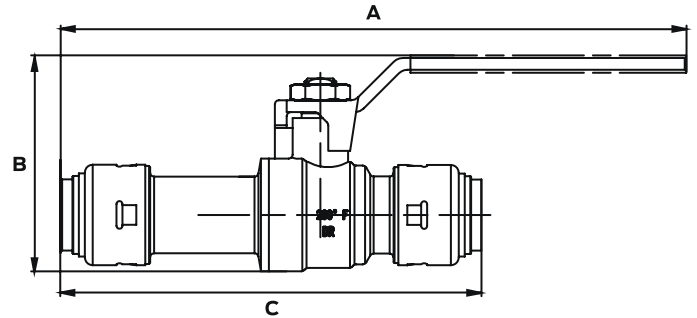

Dimensions (inches)

Part #	Size	A	B	C
UR24735	1/2"	6.2	2.1	4.2
UR24736	3/4"	6.7	2.4	4.9

Product Submittal

Name	
Date	
Architect/Owner	
Contractor	
Tag	
Notes	