

# Submittal Package

**viega**



## Viega PureFlow® Crimp Zero Lead Eco Brass® Fittings\*

**Project:**

**Engineer:**

**Contractor:**

**Submitted By:**

Potable Water

Other \_\_\_\_\_

\*Eco Brass® is a registered trademark of Chase Brass and Ingot Metal Co.

**Viega LLC • 585 Interlocken Blvd. • Broomfield, CO 80021 • Phone (800) 976-9819 • [www.viega.us](http://www.viega.us)**

# Submittal Package

**viega**

## Viega PureFlow Crimp Zero Lead Eco Brass Fittings

### Technical Data

Materials:

Fittings.....	Eco Brass®
Crimp Rings.....	Copper (black)
MANABLOC® Manifolds.....	Polysulfone (plastic) with Eco Brass or PolyAlloy™ fittings
PureFlow Crimp Copper Manifolds.....	Copper with Eco Brass alloy fittings
PureFlow Crimp Poly Manifolds.....	PolyAlloy crimp connections
Valves.....	Eco Brass and PolyAlloy
Viega PureFlow PEX Tubing.....	PEX (crosslinked polyethylene)

### Applications

PureFlow Crimp Zero Lead Brass and PureFlow Crimp PolyAlloy fittings are intended for use in potable water systems. They can be directly buried in soil but shall be wrapped (fittings used in concrete shall also be wrapped). Fittings are manufactured with PureFlow Crimp barsbs for use with Viega PureFlow, crimp rings and tools.

### Installation

- Use only ASTM F1807 crimp rings and approved full circle crimp tools to make connections.
- Keep flame and excessive heat away from tubing and connections.
- Refer to the PureFlow Water Systems Installation Manual for additional information.

“Zero Lead” identifies Viega® products meeting the lead free requirements of NSF 61-G through testing under NSF/ANSI 372 (0.25% or less maximum weighted average lead content).

### Codes Approvals & Standards

ANSI/NSF 61-G

cNSF® us pw-G

CSA B137.5

U.P. Code

UPC®

ASTM F876 / F877

ASTM F1807 / F2159

ICC ES-PMG™ 1038

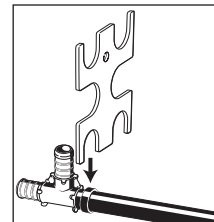
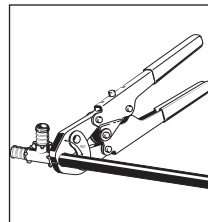
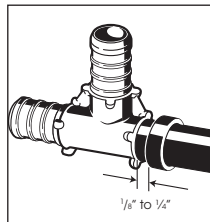

### THREE SIMPLE STEPS TO A SECURE Pure-Flow Crimp FITTING CONNECTION.

1. SLIDE CRIMP RING OVER END OF SQUARED OFF TUBING, FULLY INSERT FITTING INTO TUBING AND POSITION THE RING 1/8" TO 1/4" FROM THE END OF TUBING.
2. KEEP THE TOOL AT 90° AND CLOSE THE HANDLES COMPLETELY. DO NOT CRIMP TWICE.
3. CHECK CRIMP WITH GO/NO GO GAUGE.

# Submittal Package



## Viega PureFlow Crimp Zero Lead Eco Brass Fittings

### Viega PureFlow PEX Tubing

Material.....PEX crosslinked polyethylene  
Temperature/Pressure Ratings...200°F at 80 psi  
  180°F at 100 psi  
  73.4°F at 160 psi  
Linear Expansion Rate.....1.1"/100'/10°F

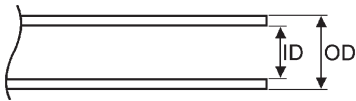

Nominal Size	Inner Diameter	Outer Diameter	Wall Thickness
3/8"	0.35	0.500±.003	0.070±.010
1/2"	0.47	0.625±.004	0.070±.010
3/4"	0.67	0.875±.004	0.097±.010
1"	0.86	1.125±.005	0.125±.013

# Submittal Package

**viega**

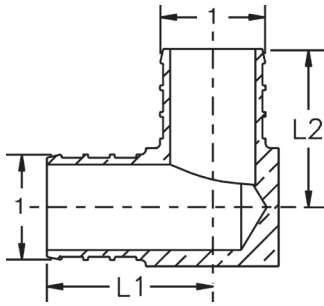

Viega PureFlow Crimp 90° Elbow Zero Lead Brass - Model V5016ZL

Part Number	Size		L1 (in)	L2 (in)
	1	2		
46922	3/8"		0.89	0.87
46933	1/2"		0.95	0.87
46243	3/4" x 1/2"		1.06	1.01
46944	3/4"		1.06	1.00
46955	1"		1.36	1.36

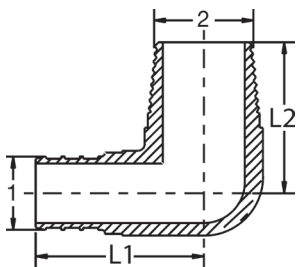

Viega PureFlow Crimp 90° Elbow Zero Lead Brass Crimp x MPT - Model V5014ZL

Part Number	Size		L1 (in)	L2 (in)
	1	2		
46822	3/8" x 3/8" M NPT		1.03	0.96
46232	1/2" x 3/8" M NPT		1.29	0.96
46821	1/2" x 1/2" M NPT		1.11	1.19
46245	3/4" x 3/4" M NPT		1.50	1.26

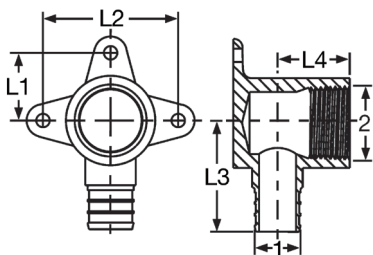

Viega PureFlow Crimp 90° Elbow Drop Ear Zero Lead Brass Crimp x FPT - Model V5027ZL

Part Number	Size		L1 (in)	L2 (in)	L3 (in)	L4 (in)
	1	2				
46233	1/2" x 1/2" F NPT		0.79	1.58	1.39	0.72
46244	3/4" x 3/4" F NPT		0.99	1.98	1.46	1.05

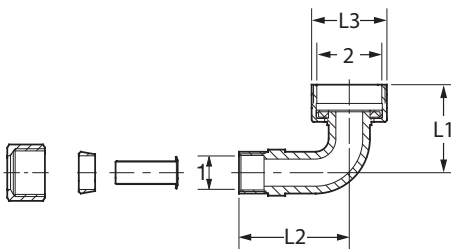

Viega PureFlow Compression 90° Elbow For Dishwasher Zero Lead Copper CTS x Hose - Model V5053

Part Number	Size		L1 (in)	L2 (in)	L3 (in)
	1	2			
46743	3/8" CTS (1/2" O.D.) Comp	3/4" Hose	1.32	1.67	1.14

# Submittal Package

**viega**

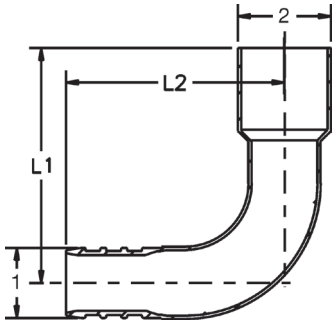

**Viega PureFlow Crimp 90° Elbow Zero Lead Copper Crimp x C - Model V5021**

Part Number	Size	L1 (in)	L2 (in)
	1 2		
44305	3/8" x 1/2" F Copper	1.68	1.46
44325	1/2" x 1/2" F Copper	1.43	1.58
44345	3/4" x 3/4" F Copper	2.05	2.01

**Viega PureFlow Crimp 90° Elbow Zero Lead Copper Crimp x FTG - Model V5020**

Part Number	Size	L1 (in)	L2 (in)
	1 2		
44302	3/8" x 1/2" M Copper	1.65	1.56
44320	1/2" x 1/2" M Copper	1.44	1.49
44340	3/4" x 3/4" M Copper	1.94	1.87

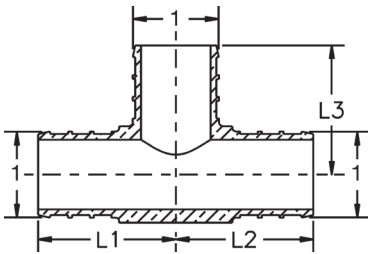

**Viega PureFlow Crimp Tee Zero Lead Brass - Model V5018ZL**

Part Number	Size	L1 (in)	L2 (in)	L3 (in)
	1			
46500	3/8"	0.89	0.89	0.88
46520	1/2"	0.95	0.95	0.88
46524	1/2" x 1/2" x 3/4"	1.07	1.07	1.01
46540	3/4"	1.07	1.07	1.00
46433	3/4" x 1/2" x 1/2"	1.20	1.20	1.10
46435	3/4" x 1/2" x 3/4"	1.07	1.12	1.01
46443	3/4" x 3/4" x 1/2"	1.07	1.07	1.01
46445	3/4" x 3/4" x 1"	1.21	1.21	1.25
46544	3/4" x 1" x 3/4"	1.20	1.39	1.10
46545	3/4" x 1" x 1"	1.21	1.39	1.28
46553	1" x 1" x 1/2"	1.39	1.39	1.10
46554	1" x 1" x 3/4"	1.39	1.39	1.10
46560	1"	1.36	1.36	1.36

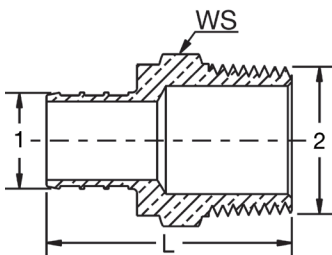

**Viega PureFlow Crimp Adapter Zero Lead Brass Crimp x MPT - Model V5011ZL**

Part Number	Size	L (in)	WS (in)
	1 2		
46302	3/8" x 1/2" M NPT	1.63	0.88
46321	1/2" x 1/2" M NPT	1.65	0.88
46324	1/2" x 3/4" M NPT	1.84	1.06
46342	3/4" x 1/2" M NPT	1.68	0.88
46340	3/4" x 3/4" M NPT	1.84	1.06
46446	3/4" x 1" M NPT	2.07	1.38
46361	1" x 3/4" M NPT	2.02	1.06
46366	1" x 1" M NPT	2.25	1.38

# Submittal Package

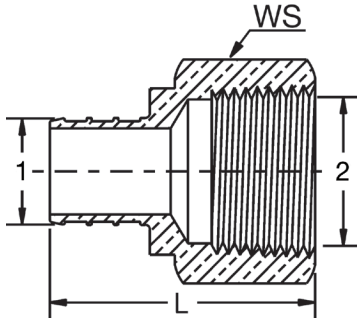

Viega PureFlow Crimp Adapter Zero Lead Brass Crimp x FPT - Model V5012ZL

Part Number	Size	L (in)	WS (in)
	1 2		
46323	3/8" x 1/2" F NPT	1.62	1.00
46333	1/2" x 1/2" F NPT	1.62	1.00
46334	1/2" x 3/4" F NPT	1.67	1.25
46344	3/4" x 3/4" F NPT	1.67	1.25
46345	3/4" x 1" F NPT	1.89	1.50
46355	1" x 1" F NPT	2.07	1.50

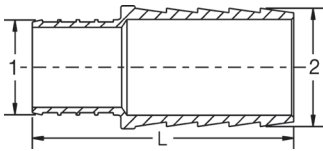

Viega PureFlow Crimp Adapter Zero Lead Brass Crimp x PB - Model V5017ZL

Part Number	Size	L (Inches)
	1 2	
46145	3/4" x 3/4" PE	1.94
46156	1" x 1" PE	2.39

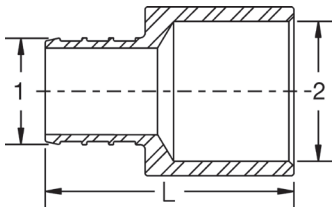

Viega PureFlow Crimp Adapter Zero Lead Brass Crimp x C - Model V5045ZL

Part Number	Size	L (in)
	1 2	
46635	1/2" x 1/2" F Sweat	1.33
46645	3/4" x 3/4" F Sweat	1.57

Viega PureFlow Crimp Adapter Zero Lead Copper Crimp x C - Model V5045ZL

Part Number	Size	L (in)
	1 2	
40655	1" x 1" F Sweat	2.13

# Submittal Package

**viega**

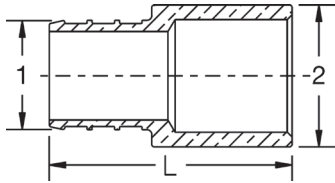

**Viega PureFlow Crimp Adapter Zero Lead Brass Crimp x FTG - Model V5046ZL**

Part Number	Size		L (in)
	1	2	
46633	1/2" x 1/2" M Sweat		1.33
46644	3/4" x 3/4" M Sweat		1.50

**Viega PureFlow Crimp Adapter Zero Lead Copper Crimp x FTG - Model V5046ZL**

Part Number	Size		L (in)
	1	2	
60651	1" x 1" M Sweat		1.97

**Viega PureFlow Crimp Adapter Zero Lead Brass Crimp x C x FTG - Model V5042ZL**

Part Number	Size		L (in)
	1	2	
46621	3/8" x 3/8" M Sweat or 1/4" F		1.33
46622	3/8" x 1/2" M Sweat or 3/8" F		1.33
46631	1/2" x 3/8" M Sweat or 1/4" F		1.46
46654	1" x 1" M Sweat or 3/4" F		1.92

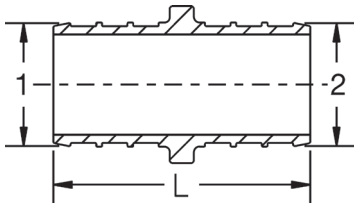

**Viega PureFlow Crimp Coupling Zero Lead Brass - Model V5015ZL**

Part Number	Size		L (Inches)
	1	2	
46422	3/8"		1.39
46432	1/2" x 3/8"		1.39
46434	1/2"		1.39
46441	3/4" X 1/2"		1.39
46444	3/4"		1.39
46454	1" X 3/4"		1.57
46455	1"		1.75

# Submittal Package

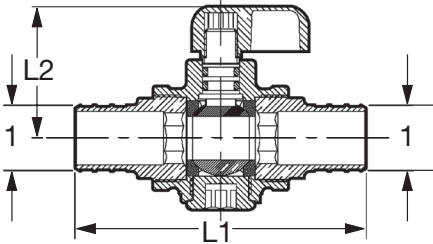

Viega PureFlow Crimp Ball Valve Zero Lead Brass ¼ Turn - Model V5037ZL

Part Number	Size	L1 (in)	L2 (in)
	1		
46010	¾"	3.09	1.20
46031	½"	2.76	1.20
46044	¾"	2.95	1.30

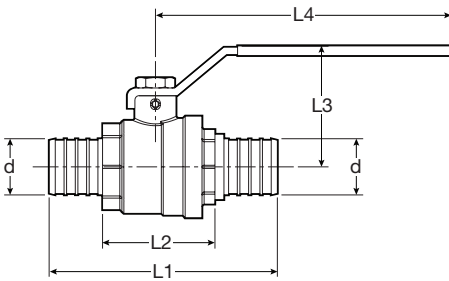

Part Number	Size	L1 (in)	L2 (in)	L3 (in)	L4 (in)
	d x d				
46060	1" x 1"	3.41	1.71	1.84	4.50

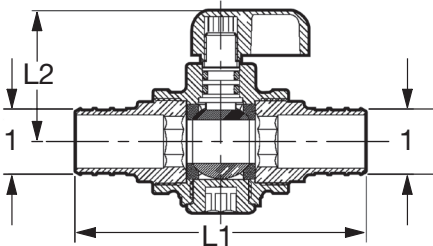

Viega PureFlow Crimp Ball Valve Zero Lead Chrome Plated Brass ¼ Turn - Model V5023ZL

Part Number	Size	L1 (in)	L2 (in)
	1		
46021	½"	2.76	1.20

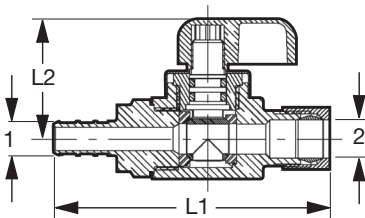

Viega PureFlow Crimp Stop Valve Straight Zero Lead Chrome Plated Brass Crimp x CTS ¼ Turn - Model V5026ZL

Part Number	Size	L1 (in)	L2 (in)
	1 2		
46001	¾" x ¼" CTS (¾" OD) Comp	2.78	1.20
46022	½" x ¼" CTS (¾" OD) Comp	2.78	1.20



# Submittal Package

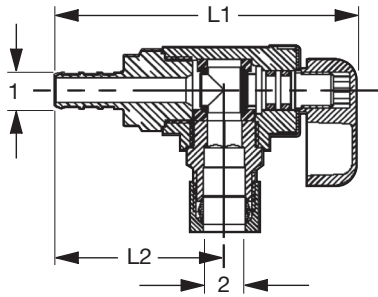

Viega PureFlow Crimp Stop Valve Angled Zero Lead Chrome Plated Brass Crimp x CTS ¼ Turn - Model V5064ZL

Part Number	Size	L1 (in)	L2 (in)
	1 2		
46002	3/8" x 1/4" CTS (3/8" OD) Comp	2.70	1.03
46025	1/2" x 1/4" CTS (3/8" OD) Comp	2.80	1.03

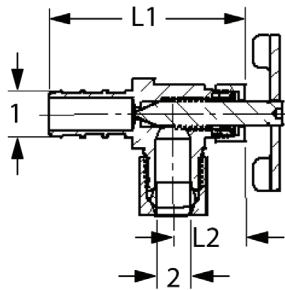

Viega PureFlow Crimp Adapter Straight Zero Lead Brass For Ice Maker Crimp x CTS - Model V5051ZL

Part Number	Size	L1 (in)	L2 (in)
	1 2		
46301	3/8" x 1/8" CTS (1/4" OD) Comp	1.48	0.55
46322	1/2" x 1/8" CTS (1/4" OD) Comp	1.48	0.55

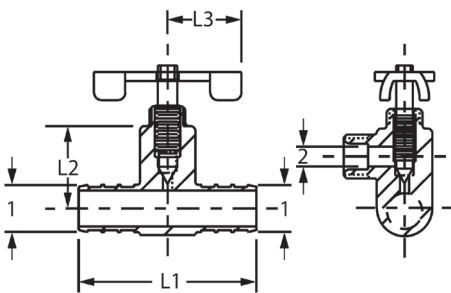

Viega PureFlow Crimp Tee Zero Lead Brass For Ice Maker Crimp x Crimp x CTS - Model V5062ZL

Part Number	Size	L1 (in)	L2 (in)	L3 (in)
	1 2			
46503	3/8" x 1/8" CTS (1/4" OD) Comp	1.83	1.03	0.59
46521	1/2" x 1/8" CTS (1/4" OD) Comp	1.83	1.03	0.59

# Submittal Package

**viega**

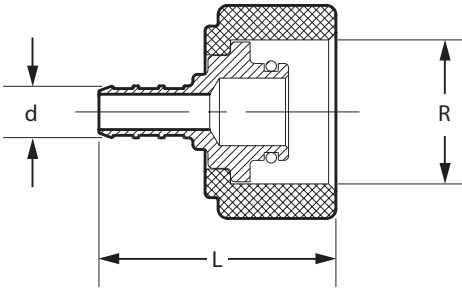

Viega PureFlow Crimp Port Adapter Zero Lead Brass For ManaBloc Crimp x Port - Model V5039ZL

Part Number	Size		L (in)
	1	2	
46624	3/8" x 1/2" Port		1.58
46634	1/2" x 1/2" Port		1.58

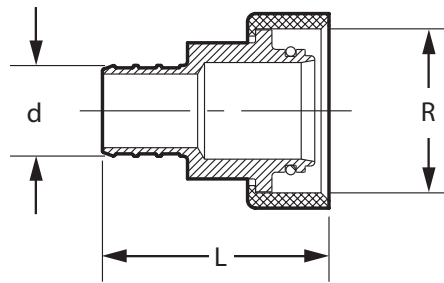

Viega PureFlow Crimp Supply Adapter Zero Lead Brass For ManaBloc Crimp x Supply - Model V5034ZL

Part Number	Size		L (in)
	1	2	
46414	3/4" x 1" ManaBloc		1.66
46416	1" x 1" ManaBloc		1.84

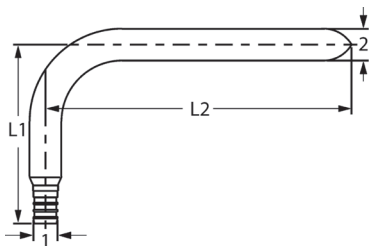

Viega PureFlow Crimp Stub-Out 90° Elbow Zero Lead Copper Crimp x Street - Model V5070

Part Number	Size		L1 (in)	L2 (in)
	1	2		
44208	3/8" x 1/2" Copper		3.50	7.75
44226	1/2" x 1/2" Copper		3.50	5.75
44228	1/2" x 1/2" Copper		3.50	7.75
44240	3/4" x 3/4" Copper		4.50	8.00

# Submittal Package

**viega**

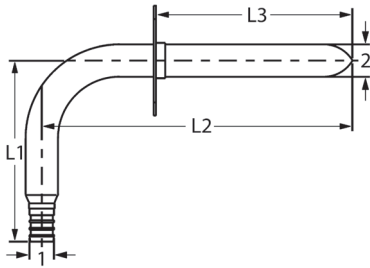

Viega PureFlow Crimp Stub-Out 90° Elbow Zero Lead Copper Crimp x Street with Wall Plate - Model V5070.1

Part Number	Size	L1 (in)	L2 (in)	L3 (in)
	1 2			
44209	3/8" x 1/2" Copper	3.50	7.75	6.00
44227	1/2" x 1/2" Copper	3.50	5.75	4.00
44229	1/2" x 1/2" Copper	3.50	7.75	6.00

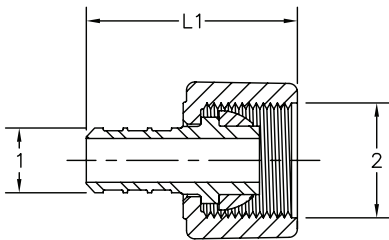

Viega PureFlow Crimp Lav Adapter Zero Lead Brass Crimp x Lav - Model V5075ZL

Part Number	Size	L1 (in)
	1 2	
46023	3/8" x 1/2" Lav (plastic nut)	1.65
46033	1/2" x 1/2" Lav (plastic nut)	1.65
46024	3/8" x 1/2" Lav (brass nut)	1.65
46034	1/2" x 1/2" Lav (brass nut)	1.65
46040	3/4" x 3/4" Lav (brass nut)	1.70

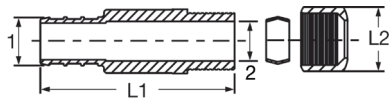

Viega PureFlow Crimp Lav Adapter Zero Lead Brass Crimp x CTS - Model V5077ZL

Part Number	Size	L1 (in)	L2 (in)
	1 2		
46032	3/8" x 1/4" CTS (3/8" OD) Comp	1.76	0.63
46331	1/2" x 1/4" CTS (3/8" OD) Comp	1.76	0.63

# Submittal Package

**viega**

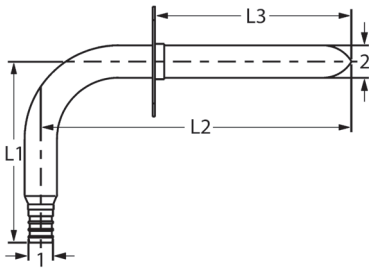

Viega PureFlow Crimp Stub-Out 90° Elbow Zero Lead Copper Crimp x Street with Wall Plate - Model V5070.1

Part Number	Size	L1 (in)	L2 (in)	L3 (in)
	1 2			
44209	3/8" x 1/2" Copper	3.50	7.75	6.00
44227	1/2" x 1/2" Copper	3.50	5.75	4.00
44229	1/2" x 1/2" Copper	3.50	7.75	6.00

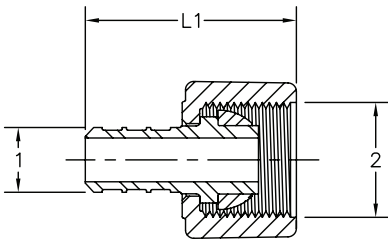

Viega PureFlow Crimp Lav Adapter Zero Lead Brass Crimp x Lav - Model V5075ZL

Part Number	Size	L1 (in)
	1 2	
46023	3/8" x 1/2" Lav (plastic nut)	1.65
46033	1/2" x 1/2" Lav (plastic nut)	1.65
46024	3/8" x 1/2" Lav (brass nut)	1.65
46034	1/2" x 1/2" Lav (brass nut)	1.65
46040	3/4" x 3/4" Lav (brass nut)	1.70

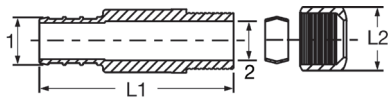

Viega PureFlow Crimp Lav Adapter Zero Lead Brass Crimp x CTS - Model V5077ZL

Part Number	Size	L1 (in)	L2 (in)
	1 2		
46032	3/8" x 1/4" CTS (3/8" OD) Comp	1.76	0.63
46331	1/2" x 1/4" CTS (3/8" OD) Comp	1.76	0.63

# Submittal Package

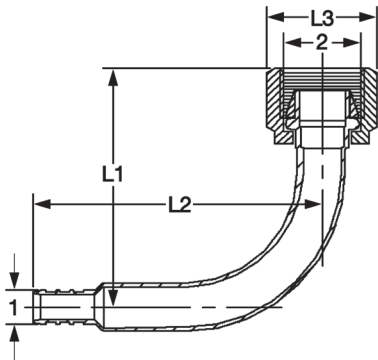

Viega PureFlow Crimp Lav 90° Elbow Zero Lead Copper Crimp x Lav - Model V5076

Part Number	Size	L1 (in)	L2 (in)	L3 (in)
	1 2			
44201	3/8" x 1/2" Lav (plastic nut)	2.25	2.73	1.12

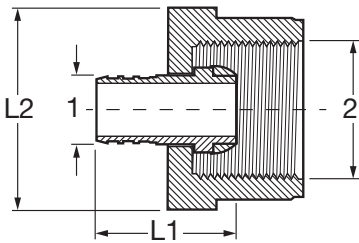

Viega PureFlow Crimp Closet Adapter Zero Lead Brass Crimp x Closet - Model V5072ZL

Part Number	Size	L1 (in)	L2 (in)
	1 2		
46223	3/8" x 1/2" Closet (plastic nut)	1.36	1.16
46234	1/2" x 1/2" Closet (plastic nut)	1.36	1.16

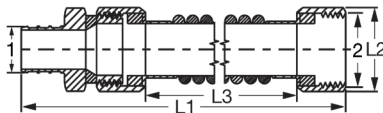

Viega PureFlow Crimp Swivel Connector Zero Lead Copper For Water Heater Crimp x FPT - Model V5048ZL

Part Number	Size	L1 (in)	L2 (in)	L3 (in)
	1 2			
46764	3/4" x 3/4" F NPT	19.00	1.13	18.00

# Submittal Package

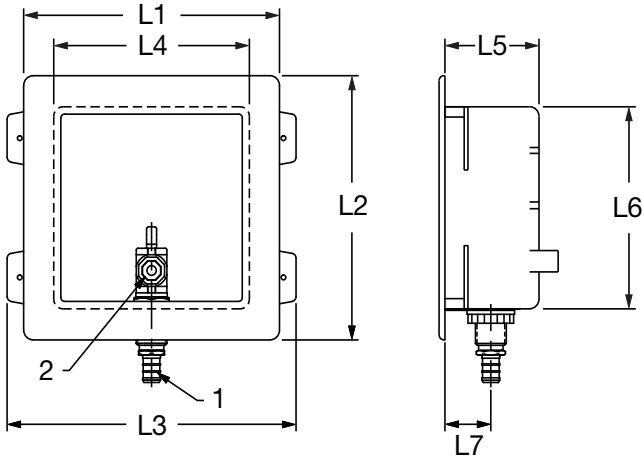

Viega PureFlow Crimp Outlet Box Zero Lead Brass For Ice Maker 1/4 Turn - Model 2872ZL

Part Number	Size		L1	L2	L3	L4	L5	L6	L7
	1	2							
46710*	3/8" x 1/8" CTS (1/4" O.D.)		6.80"	6.80"	7.68"	5.20"	2.50"	5.20"	1.22"
46720*	1/2" x 1/8" CTS (1/4" O.D.)		6.80"	6.80"	7.68"	5.20"	2.50"	5.20"	1.22"
43700	3/8" x 1/8" CTS (1/4" O.D.)		6.80"	6.80"	7.68"	5.20"	2.50"	5.20"	1.22"
43722	1/2" x 1/8" CTS (1/4" O.D.)		6.80"	6.80"	7.68"	5.20"	2.50"	5.20"	1.22"

\* with hammer arrestor

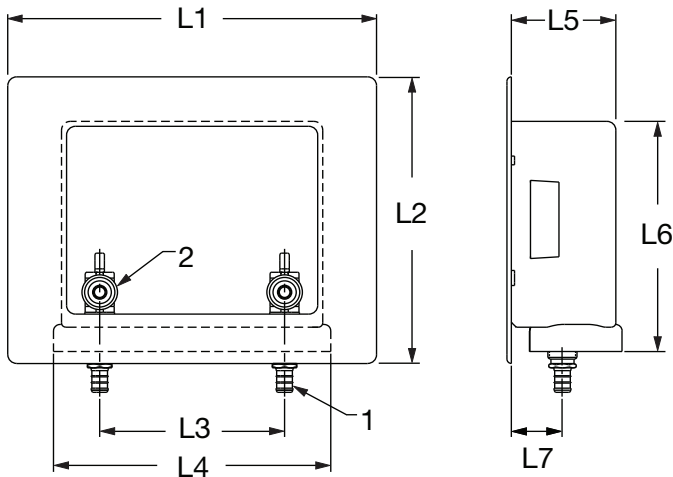

Viega PureFlow Crimp Outlet Box Zero Lead Brass For Washing Machine 1/4 Turn - Model 2872.9ZL

Part Number	Size		L1	L2	L3	L4	L5	L6	L7
	1	2							
46730*	1/2" x 3/4" Hose		10.40"	8.30"	5.20"	7.40"	2.90"	6.60"	1.43"
43720	1/2" x 3/4" Hose		10.40"	8.30"	5.20"	7.40"	2.90"	6.60"	1.43"

\* with hammer arrestor

# Submittal Package

**viega**

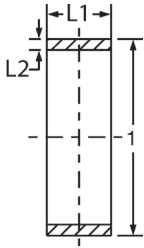

Viega PureFlow Crimp Ring Copper - Model V5019.9

Part Number	Size	L1 (in)	L2 (in)
	1		
43600	3/8"	0.32	0.05
43620	1/2"	0.32	0.05
43640	3/4"	0.32	0.05
43660	1"	0.36	0.04

\*Zero Lead identifies Viega® products meeting the lead free requirements of NSF 61-G through testing under NSF/ANSI 372 (0.25% or less maximum weighted average lead content).

**Viega products are designed to be installed by licensed and trained plumbing and mechanical professionals who are familiar with Viega products and their installation. *Installation by non-professionals may void Viega LLC's warranty.***

This document is subject to updates. For the most current Viega technical literature please visit [www.viega.us](http://www.viega.us).

**Viega LLC • 585 Interlocken Blvd. • Broomfield, CO 80021 • Phone (800) 976-9819 • [www.viega.us](http://www.viega.us)**