

# PRODUCT SUBMITTAL 975

## SDR11 Carbon Steel Welding Ends

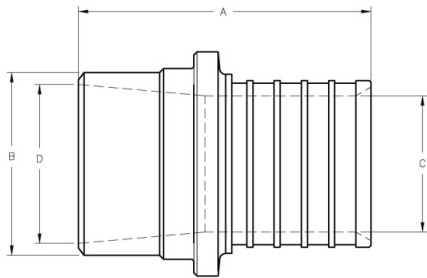

**Product:** SDR11 Carbon Steel Welding Ends  
**Date:** 19 September 2022 (supersedes 01 July 2019)



Article No.	Nominal Size in.	A in.	B in.	C in.	D in.
425622-001	25mm SDR11 x NPS 3/4 in.	1.969	1.051	0.701	0.822
425624-001	32mm SDR11 x NPS 1 in.	2.362	1.315	0.914	1.049
425626-001	40mm SDR11 x NPS 1 1/4 in.	2.756	1.661	1.083	1.381
425627-001	50mm SDR11 x NPS 1 1/2 in.	3.346	1.902	1.409	1.612
221807-001	63 mm SDR11 x NPS 2 in.	3.803	2.375	1.772	2.067
221817-001	75 mm SDR11 x NPS 2 1/2 in.	4.112	2.875	2.126	2.469
221827-001	90 mm SDR11 x NPS 3 in.	4.362	3.500	2.717	3.068
221837-001	110 mm SDR11 x NPS 4 in.	4.431	4.500	3.288	4.026
298256-001	125 mm SDR11 x NPS 4 in.	4.543	4.500	3.543	4.026
425628-001	140mm SDR11 x NPS 5 in.	4.409	5.563	3.976	5.039

### TECHNICAL DESCRIPTION

Specification	See description below
Material	Machined from Schedule 40 carbon steel

### FUNCTIONAL DESCRIPTION

SDR11 compression-sleeve carbon steel welding ends are designed to be welded to steel pipes and fittings (carbon steel). This allows the user to fabricate custom tees and to adapt INSULPEX® with RAUTHERM-FW pipe to steel pipe used for custom tee fabrication. Carbon steel welding ends are machined from Schedule 40 carbon steel, meeting the requirements of ASTM A108 alloy 1020 or 1025, or ASTM A519 alloy 1020, 1025 or 1026. SDR11 compression-sleeve carbon steel welding ends are for use on closed systems with air removal devices. SDR11 compression-sleeve carbon steel welding ends are not suitable for potable water applications.

For updates to this publication, visit [na.rehau.com/resourcecenter](http://na.rehau.com/resourcecenter)

The information contained herein is believed to be reliable, but no representations, guarantees or warranties of any kind are made as to its accuracy, suitability for particular applications or the results to be obtained therefrom. Before using, the user will determine suitability of the information for user's intended use and shall assume all risk and liability in connection therewith. © 2022 REHAU