

*For Residential and Commercial Applications*

Job Name		Engineer / Architect	
Job Location		Wholesaler	
Submittal Date		Contractor	

## 1-12DE/ 1-20DE/ 1-30DE/ 3-12DE    **Copper Toilet Riser** w/ Heavy Duty Rubber Nosepiece

**Use:** For use in potable water distribution systems in accessible locations only.

**Design Features:**

- **One-piece construction**
- **Cut-to-Length** for clean, professional installation
- 

**Operating Specifications:**

**Temperature:** 40° - 180° F  
**Pressure:** 125 PSI maximum

**Tubing Diameter:** 0.38" OD or 0.50" OD

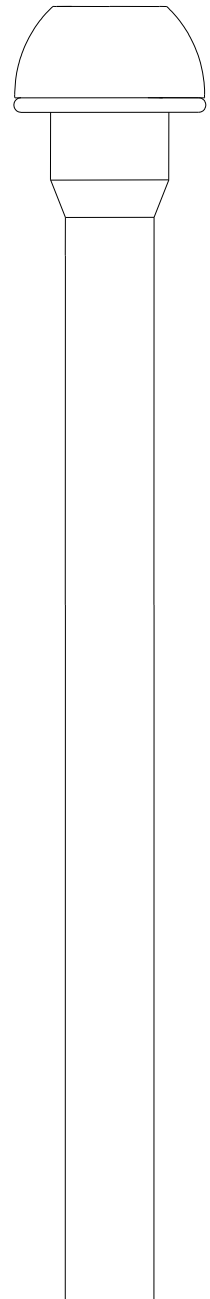

**CONNECTOR MATERIAL SPECIFICATIONS**

<b>Tube</b>	<i>Copper</i>
<b>Nosepiece Support</b>	<i>POM</i>
<b>Washer</b>	<i>Rubber</i>

**Part Listing:**

- 1-12DE C      3/8" OD tube x 11-1/2" length, chrome plated
- 1-12DE CBT    3/8" OD tube x 11-1/2" length, chrome plated, plain label, bulk
- 1-12DE-1 R    3/8" OD tube x 11-1/2" length, no washer, rough finish
- 1-12DE BZP    3/8" OD tube x 11-1/2" length, oil rubbed bronze, bagged
- 1-12DE NSP    3/8" OD tube x 11-1/2" length, satin nickel, bagged
- 1-20DE C      3/8" OD tube x 19-1/2" length, chrome plated
- 1-20DE CBT    3/8" OD tube x 19-1/2" length, chrome plated, plain label, bulk
- 1-20DE-1 R    3/8" OD tube x 19-1/2" length, no washer, rough finish
- 1-20DE BZP    3/8" OD tube x 19-1/2" length, oil rubbed bronze, bagged
- 1-20DE NSP    3/8" OD tube x 19-1/2" length, satin nickel, bagged
- 1-30DE C      3/8" OD tube x 29-1/2" length, chrome plated
- 3-12DE C      1/2" OD tube x 11-1/2" length, chrome plated

*This specification and all information contained herein is the confidential and exclusive property of Brasscraft Manufacturing Company and shall not be disclosed to others without the written consent of Brasscraft Mfg. Co. This specification must be returned to Brasscraft Mfg. Co. if requested.*

# 1-12DE/ 1-20DE/ 1-30DE/ 3-12DE Copper Toilet Riser w/ Heavy Duty Rubber Nosepiece

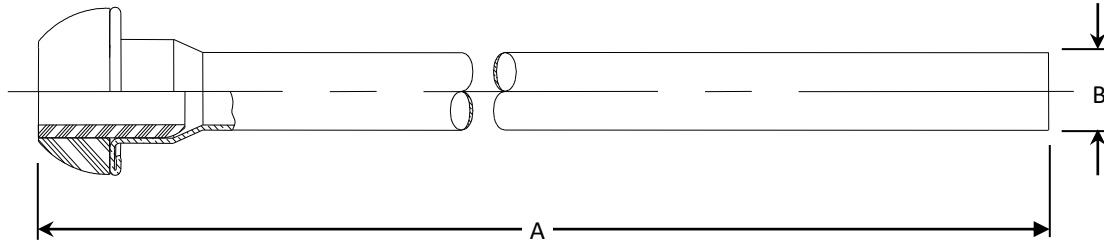

<b>PART DIMENSIONS (Inches)</b>		
<b>Model</b>	<b>DIM. A</b>	<b>DIA. B</b>
1-12DE	11.56	3/8
1-20DE	19.56	3/8

<b>PART DIMENSIONS (Inches)</b>		
<b>Model</b>	<b>DIM. A</b>	<b>DIA. B</b>
1-30DE	29.56	3/8
3-12DE	11.56	1/2

**Listings & Certifications:**

- IAPMO listed to ASME A112.18.1 / CSA B125.1 (including NSF/ANSI 372 and NSF/ANSI/CAN 61)



*This specification and all information contained herein is the confidential and exclusive property of Brasscraft Manufacturing Company and shall not be disclosed to others without the written consent of Brasscraft Mfg. Co. This specification must be returned to Brasscraft Mfg. Co. if requested.*